

NOTICE!!

These documents have been scanned!

Do not place un-scanned documents beneath this notice!

Do not remove this notice from this file!

GPO Jacket No. 560-102
Print Order 61540
Rise Business Services, LLC
Job=AZ15 5/10/2019



Box Number= AZ15035



Claim Begin-End: AMC426089-AMC426089

1 Initial Receipt



AZ15035-21

AMC425596-AMC426147

United States Department of the Interior
Bureau of Land Management
 LANDS/RECREATION & PLANNING
 ONE N CENTRAL AVE
 PHOENIX, AZ 85004 -2203
 Phone: 602-417-9200

ENTERED
 JAN 07 2014
 BY: *[Signature]*

Receipt

No: 2942589

| | |
|--|--|
| Transaction #: 3030279 | |
| Date of Transaction: 01/02/2014 | |
| CUSTOMER: | |
| TERRANCE MIYAUCHI 3408 SOUTHERN VISTA DR KINGMAN, AZ 86401-0629 US | |

| LINE # | QTY | DESCRIPTION | REMARKS | UNIT PRICE | TOTAL |
|---------------|------|---|---------|------------|-----------------|
| 1 | 1.00 | LOCATABLE MINERALS / MINING CLAIMS-NEW, UNADJUD, ONE OR MORE AUTH NOS / NEW MINING CLAIM LOCATION FEE \$34 CASES: AMC426089/\$34.00 | | - n/a - | 34.00 |
| 2 | 1.00 | LOCATABLE MINERALS / MINING CLAIMS-NEW, UNADJUD, ONE OR MORE AUTH NOS / NEW MINING CLAIM MAINT FEE \$140 CASES: AMC426089/\$140.00 | | - n/a - | 140.00 |
| 3 | 1.00 | LOCATABLE MINERALS / MINING CLAIMS-NEW, UNADJUD, ONE OR MORE AUTH NOS / NEW MINING CLAIM PROCESSING FEE CASES: AMC426089/\$20.00 | | - n/a - | 20.00 |
| TOTAL: | | | | | \$194.00 |

| PAYMENT INFORMATION | | | |
|---------------------|-----------|---|------------------------|
| 1 | AMOUNT: | 194.00 | POSTMARKED: 12/27/2013 |
| | TYPE: | CHECK | RECEIVED: 12/30/2013 |
| | CHECK NO: | 2900 | |
| | NAME: | MIYAUCHI, TERENCE SCOTT 3408 SOUTHERN VISTA DR KINGMAN AZ 86401-0629 US | |

| |
|---------|
| REMARKS |
| |

This receipt was generated by the automated BLM Collections and Billing System and is a paper representation of a portion of the official electronic record contained therein.

NOTICE!!

These documents have been scanned!

Do not place un-scanned documents beneath this notice!

Do not remove this notice from this file!

GPO Jacket No. 560-102
Print Order 61540
Rise Business Services, LLC
Job=AZ15 5/10/2019



Box Number= AZ15035



Claim Begin-End: AMC426089-AMC426089

2 Correspondence



AZ15035-21

AMC425596-AMC426147

**NO
DOCUMENTS
FOUND**

NO DOCUMENTS FOUND
NO DOCUMENTS FOUND

NOTICE!!

These documents have been scanned!

Do not place un-scanned documents beneath this notice!

Do not remove this notice from this file!

GPO Jacket No. 560-102
Print Order 61540
Rise Business Services, LLC
Job=AZ15 5/10/2019



Box Number= AZ15035



Claim Begin-End: AMC426089-AMC426089

3 Transfers



AZ15035-21

AMC425596-AMC426147

**NO
DOCUMENTS
FOUND**

NO DOCUMENTS FOUND
NO DOCUMENTS FOUND

NOTICE!!

These documents have been scanned!

Do not place un-scanned documents beneath this notice!

Do not remove this notice from this file!

GPO Jacket No. 560-102
Print Order 61540
Rise Business Services, LLC
Job=AZ15 5/10/2019



Box Number= AZ15035



Claim Begin-End: AMC426089-AMC426089

4 Miscellaneous



AZ15035-21

AMC425596-AMC426147

**NO
DOCUMENTS
FOUND**

NO DOCUMENTS FOUND
NO DOCUMENTS FOUND

NOTICE!!

These documents have been scanned!

Do not place un-scanned documents beneath this notice!

Do not remove this notice from this file!

GPO Jacket No. 560-102
Print Order 61540
Rise Business Services, LLC
Job=AZ15 5/10/2019



Box Number= AZ15035



Claim Begin-End: AMC426089-AMC426089

5 Annual Filings



AZ15035-21

AMC425596-AMC426147

UNITED STATES
DEPARTMENT OF THE INTERIOR
BUREAU OF LAND MANAGEMENT
MAINTENANCE FEE WAIVER CERTIFICATION

206
[Handwritten signature]

426089

FORM APPROVED
OMB NO. 1004-0114
Expires: April 30, 2023

SEE INSTRUCTIONS ON PAGE 2

- This small miner waiver is filed for the assessment year beginning on September 1, 2020 and ending on September 1, 2021.
- The undersigned and all related parties owned ten or fewer mining claims, mill, or tunnel sites located and maintained on Federal lands in the United States of America on September 1, 2020.
- The undersigned have performed the assessment work required by law for each mining claim listed prior to filing this waiver and understand that by filing this form, the undersigned must file an affidavit of assessment work with the Bureau of Land Management (BLM) by the December 30th following the filing of this waiver.
- The undersigned understand that if the assessment work obligation has not yet come due under 30 U.S.C. 28 (for those claims in their first assessment year only), a notice of intent to hold reciting this condition must be recorded by the December 30th following the filing of this waiver.
- The undersigned understand that mill and tunnel sites may also be listed on this waiver and be waived from payment of the maintenance fee, and that a notice of intent to hold for these sites is required to be filed with the BLM by the December 30th following the filing of this waiver.
- The undersigned understand and acknowledge that pursuant to 43 U.S.C. 1212 and 18 U.S.C. 1001, the filing or recording of a false, fictitious, or fraudulent document with the BLM may result in a fine of up to \$250,000, a prison term not to exceed five years, or both.
- The mining claims, mill or tunnel sites for which this waiver from payment of the maintenance fees is requested are:

| CLAIM OR SITE NAME | BLM RECORDATION SERIAL NUMBER |
|--------------------|-------------------------------|
| 1. AU DIGGER | AMC 426089 |
| 2. | |
| 3. | |
| 4. | |
| 5. | |
| 6. | |
| 7. | |
| 8. | |
| 9. | |
| 10. | |

The owner(s) (claimants) of the above mining claims and sites are:

B AND N MINING Co. LLC
(Owner's Name - Please Print)
620 BALDWIN ST
(Owner's Mailing Address)

Heather Nightingale
(Owner's Original Signature) MEMBER
MANAGING
GALVA KS 67443
(City) (State) (Zip Code)

(Owner's Name - Please Print)

(Owner's Original Signature)

(Owner's Mailing Address)

(City)

(State)

(Zip Code)

(Owner's Name - Please Print)

(Owner's Original Signature)

(Owner's Mailing Address)

(City)

(State)

(Zip Code)

(Owner's Name - Please Print)

(Owner's Original Signature)

(Owner's Mailing Address)

(City)

(State)

(Zip Code)

(Continued on page 3)

RECEIVED
BLM STATE OFFICE
PHOENIX, ARIZONA
2020 AUG 14 A 7:52

9/4/2020 486 ENTERED. RM

[Handwritten initials]



United States Department of the Interior

BUREAU OF LAND MANAGEMENT
Arizona State Office
One North Central Avenue, Suite 800
Phoenix, Arizona 85004-4427
www.blm.gov/az/
SEP 30 2020



In Reply Refer To:

3800 (9200) RM

AMC405019, AMC426089, AMC450147, AMC458203, AMC459219

CERTIFIED MAIL - RETURN RECEIPT REQUESTED 9214 8901 9403 8321 8510 86

DECISION

DELMAR NIGHTINGALE
1224 23RD AVE
GALVA, KS 67443-8873

AMC405019, AMC405020, AMC426089, AMC450147, AMC450148, AMC458203 -
AMC458206, AMC459219, AMC459220
CW 1, CW 2, AU DIGGER, RAINBOWS END NORTH, RAINBOWS END SOUTH, AU
DIGGER #2, AU DIGGER #3, AU DIGGER #4, AU DIGGER #5, AU DIGGER 6, AU
DIGGER 7

Maintenance Fee Waiver Certifications Denied Mining Claims Declared Forfeited

The Maintenance Fee Waiver Certifications (small miner waivers) filed for the 2021 assessment year, for the mining claims listed above, are denied. Because the small miner waivers are denied and because the required maintenance fee payments due on or before September 1, 2020, were not paid, these claims are declared forfeited.

The Bureau of Land Management's (BLM) regulations at 43 CFR 3830.21, and 3834.11(a)(2) state that by September 1 of each year, holders of mining claims must pay an annual maintenance fee of \$165 per claim per 20 acres or portion thereof. In lieu of paying the required maintenance fee, claimants may submit a valid small miner waiver, in accordance with 43 CFR 3835.1, 3835.10, and 3835.11.

In accordance with 43 CFR 3835.1(b), to qualify for a small miner waiver, you and all related parties must hold no more than a total of 10 mining claims or sites nationwide. As defined at 43 CFR 3830.5, "related party means: a) the spouse and dependent children of the claimant as defined in section 152 of the Internal Revenue Code of 1986 [26 U.S.C. section 152]; or, b) A person who controls, is controlled by, or is under common control with the claimant." "Control means actual control, legal control, or the power to exercise control, through or by common directors, officers, stockholders, a voting trust, or a holding company or Investment Company, or any other means."

Small miner waivers were filed for the eleven mining claims listed above. The BLM has reviewed the case files for each of the mining claims listed above to verify that the owners qualify for a small miner waiver. The BLM has made the following findings:

1. The waivers submitted on the above claims are all signed by Delmar Nightingale, either as owner, member, or managing member.
2. Ownership of the mining claims is as follows:

| AMC NUMBER | CLAIM NAME | B and N Mining LLC | Delmar Nightingale |
|------------|---------------------|--------------------|--------------------|
| AMC405019 | CW 1 | | X |
| AMC405020 | CW 2 | | X |
| AMC426089 | AU DIGGER | X | |
| AMC450147 | RAINBOW'S END NORTH | X | |
| AMC450148 | RAINBOW'S END SOUTH | X | |
| AMC458203 | AU DIGGER 2 | X | |
| AMC458204 | AU DIGGER 3 | X | |
| AMC458205 | AU DIGGER 4 | X | |
| AMC458206 | AU DIGGER 5 | X | |
| AMC459219 | AU DIGGER 6 | X | |
| AMC459220 | AU DIGGER 7 | X | |

3. Additionally, B and N Mining LLC owns 18 mining claims in Nevada, numbers NMC1192221, NMC1192222, NMC1198305 – NMC1198320. The 2021 maintenance fees were paid on the Nevada mining claims.

In accordance with 43 C.F.R. 3835.92(d), because you or a co-claimant own more than 10 mining claims or sites and submitted a small miner waiver request and failed to pay the required maintenance fee on or before the due date for the 2021 assessment year, the mining claims listed above are declared forfeited and void as of September 1, 2020. Additionally you and the co-claimants may be subject to criminal penalties under 18 U.S.C. 1001.

Reclamation Requirements

This decision does not relieve you of the liability for reclamation of all areas disturbed by your activities on lands covered by the subject mining claim(s) and/or site(s). After you complete the reclamation, you must notify the authorized officer of the appropriate surface managing agency so that the authorized officer may conduct a final site inspection and determine whether you may be released from liability. If you fail to reclaim the land to the satisfaction of the authorized officer, the surface management agency may cite you for noncompliance under its surface management regulations.

For land administered by the BLM, if you fail to reclaim the land to the satisfaction of the authorized officer as required in 43 CFR Subpart 3809, the BLM will issue an order of noncompliance under 43 CFR 3809.601(a). If you fail to comply with the noncompliance order, the BLM may take further action under 43 CFR 3809.604. Failure to conduct reclamation is a prohibited act that may subject you to criminal penalties. (See 43 CFR 3809.605(h) and 43 CFR 3809.700)

Appeal Procedures

This decision may be appealed to the Interior Board of Land Appeals (IBLA), Office of the Secretary, in accordance with the regulations contained in 43 CFR Part 4, and the enclosed Form 1842-1. If an appeal is taken, your notice of appeal must be filed in this office (at the above address) within 30 days from receipt of this decision. The appellant has the burden of showing that the decision appealed from is in error.

If you wish to file a petition pursuant to regulation 43 CFR 4.21 (58 FR 4939, January 19, 1993) for a stay of the effectiveness of this decision during the time that your appeal is being reviewed by the Board, the petition for a stay must accompany your notice of appeal. A petition for a stay is required to show sufficient justification based on the standards listed below. Copies of the notice of appeal and petition for a stay must also be submitted to each party named in this decision and to the IBLA and to the appropriate Office of the Solicitor (see 43 CFR 4.413) at the same time the original documents are filed with this office. If you request a stay, you have the burden of proof to demonstrate that a stay should be granted.

Standards for Obtaining a Stay

Except as otherwise provided by law or other pertinent regulation, a petition for a stay of a decision pending appeal shall show sufficient justification based on the following standards:

- (1) The relative harm to the parties if the stay is granted or denied,
- (2) The likelihood of the appellant's success on the merits,
- (3) The likelihood of immediate and irreparable harm if the stay is not granted, and
- (4) Whether the public interest favors granting the stay.

Please include your AMC serial number(s) on all correspondence. If additional information is required, please contact RéAnn Myers at 602-417-9413.

Amy F. DePestel

Amy F. DePestel
Supervisory Land Law Examiner
Lands, Minerals and Energy Division

Enclosures



United States Department of the Interior

BUREAU OF LAND MANAGEMENT

Arizona State Office

One North Central Avenue, Suite 800

Phoenix, Arizona 85004-4427

www.blm.gov/az/

SEP 30 2020



In Reply Refer To:

3800 (9200) RM

AMC405019, AMC426089, AMC450147, AMC458203, AMC459219

CERTIFIED MAIL - RETURN RECEIPT REQUESTED 9214 8901 9403 8321 8512 08

DECISION

B AND N MINING LLC
620 BALDWIN ST
GALVA, KS 67443-8714

AMC405019, AMC405020, AMC426089, AMC450147, AMC450148, AMC458203 -
AMC458206, AMC459219, AMC459220
CW 1, CW 2, AU DIGGER, RAINBOWS END NORTH, RAINBOWS END SOUTH,
AU DIGGER #2, AU DIGGER #3, AU DIGGER #4, AU DIGGER #5, AU DIGGER 6,
AU DIGGER 7

Maintenance Fee Waiver Certifications Denied Mining Claims Declared Forfeited

The Maintenance Fee Waiver Certifications (small miner waivers) filed for the 2021 assessment year, for the mining claims listed above, are denied. Because the small miner waivers are denied and because the required maintenance fee payments due on or before September 1, 2020, were not paid, these claims are declared forfeited.

The Bureau of Land Management's (BLM) regulations at 43 CFR 3830.21, and 3834.11(a)(2) state that by September 1 of each year, holders of mining claims must pay an annual maintenance fee of \$165 per claim per 20 acres or portion thereof. In lieu of paying the required maintenance fee, claimants may submit a valid small miner waiver, in accordance with 43 CFR 3835.1, 3835.10, and 3835.11.

In accordance with 43 CFR 3835.1(b), to qualify for a small miner waiver, you and all related parties must hold no more than a total of 10 mining claims or sites nationwide. As defined at 43 CFR 3830.5, "related party means: a) the spouse and dependent children of the claimant as defined in section 152 of the Internal Revenue Code of 1986 [26 U.S.C. section 152]; or, b) A person who controls, is controlled by, or is under common control with the claimant." "Control means actual control, legal control, or the power to exercise control, through or by common directors, officers, stockholders, a voting trust, or a holding company or Investment Company, or any other means."

Small miner waivers were filed for the eleven mining claims listed above. The BLM has reviewed the case files for each of the mining claims listed above to verify that the owners qualify for a small miner waiver. The BLM has made the following findings:

1. The waivers submitted on the above claims are all signed by Delmar Nightingale, either as owner, member, or managing member.
2. Ownership of the mining claims is as follows:

| AMC NUMBER | CLAIM NAME | B and N Mining LLC | Delmar Nightingale |
|------------|---------------------|--------------------|--------------------|
| AMC405019 | CW 1 | | X |
| AMC405020 | CW 2 | | X |
| AMC426089 | AU DIGGER | X | |
| AMC450147 | RAINBOW'S END NORTH | X | |
| AMC450148 | RAINBOW'S END SOUTH | X | |
| AMC458203 | AU DIGGER 2 | X | |
| AMC458204 | AU DIGGER 3 | X | |
| AMC458205 | AU DIGGER 4 | X | |
| AMC458206 | AU DIGGER 5 | X | |
| AMC459219 | AU DIGGER 6 | X | |
| AMC459220 | AU DIGGER 7 | X | |

3. Additionally, B and N Mining LLC owns 18 mining claims in Nevada, numbers NMC1192221, NMC1192222, NMC1198305 – NMC1198320. The 2021 maintenance fees were paid on the Nevada mining claims.

In accordance with 43 C.F.R. 3835.92(d), because you or a co-claimant own more than 10 mining claims or sites and submitted a small miner waiver request and failed to pay the required maintenance fee on or before the due date for the 2021 assessment year, the mining claims listed above are declared forfeited and void as of September 1, 2020. Additionally you and the co-claimants may be subject to criminal penalties under 18 U.S.C. 1001.

Reclamation Requirements

This decision does not relieve you of the liability for reclamation of all areas disturbed by your activities on lands covered by the subject mining claim(s) and/or site(s). After you complete the reclamation, you must notify the authorized officer of the appropriate surface managing agency so that the authorized officer may conduct a final site inspection and determine whether you may be released from liability. If you fail to reclaim the land to the satisfaction of the authorized officer, the surface management agency may cite you for noncompliance under its surface management regulations.

For land administered by the BLM, if you fail to reclaim the land to the satisfaction of the authorized officer as required in 43 CFR Subpart 3809, the BLM will issue an order of noncompliance under 43 CFR 3809.601(a). If you fail to comply with the noncompliance order, the BLM may take further action under 43 CFR 3809.604. Failure to conduct reclamation is a prohibited act that may subject you to criminal penalties. (See 43 CFR 3809.605(h) and 43 CFR 3809.700)

Appeal Procedures

This decision may be appealed to the Interior Board of Land Appeals (IBLA), Office of the Secretary, in accordance with the regulations contained in 43 CFR Part 4, and the enclosed Form 1842-1. If an appeal is taken, your notice of appeal must be filed in this office (at the above address) within 30 days from receipt of this decision. The appellant has the burden of showing that the decision appealed from is in error.

If you wish to file a petition pursuant to regulation 43 CFR 4.21 (58 FR 4939, January 19, 1993) for a stay of the effectiveness of this decision during the time that your appeal is being reviewed by the Board, the petition for a stay must accompany your notice of appeal. A petition for a stay is required to show sufficient justification based on the standards listed below. Copies of the notice of appeal and petition for a stay must also be submitted to each party named in this decision and to the IBLA and to the appropriate Office of the Solicitor (see 43 CFR 4.413) at the same time the original documents are filed with this office. If you request a stay, you have the burden of proof to demonstrate that a stay should be granted.

Standards for Obtaining a Stay

Except as otherwise provided by law or other pertinent regulation, a petition for a stay of a decision pending appeal shall show sufficient justification based on the following standards:

- (1) The relative harm to the parties if the stay is granted or denied,
- (2) The likelihood of the appellant's success on the merits,
- (3) The likelihood of immediate and irreparable harm if the stay is not granted, and
- (4) Whether the public interest favors granting the stay.

Please include your AMC serial number(s) on all correspondence. If additional information is required, please contact RéAnn Myers at 602-417-9413.



Amy F. DePestel
Supervisory Land Law Examiner
Lands, Minerals and Energy Division

Enclosures

Date Produced: 10/12/2020

ConnectSuite Inc.:

The following is the delivery information for Certified Mail™/RRE item number 9214 8901 9403 8321 8512 08. Our records indicate that this item was delivered on 10/05/2020 at 02:43 p.m. in MCPHERSON, KS 67460. The scanned image of the recipient information is provided below.

Signature of Recipient :
(Authorized Agent)

APC19R4

Address of Recipient :

620 Baldwin

Thank you for selecting the Postal Service for your mailing needs. If you require additional assistance, please contact your local post office or Postal Service representative.

Sincerely,
United States Postal Service

The customer reference number shown below is not validated or endorsed by the United States Postal Service. It is solely for customer use.

Customer Reference Number: C2295416.13061763

FEE# 2018058115

OFFICIAL RECORDS
OF MOHAVE COUNTY
KRISTI BLAIR,
COUNTY RECORDER



448767
451341

11/23/2018 04:12 PM Fee: \$10.00

PAGE: 1 of 2

426089

NOTICE OF INTENTION TO HOLD MINING CLAIMS/SITES

When Recorded Return Document to:

JACOB MIYAUCHI
925 N. COLLEGE AVE #F222
TEMPE, AZ 85281

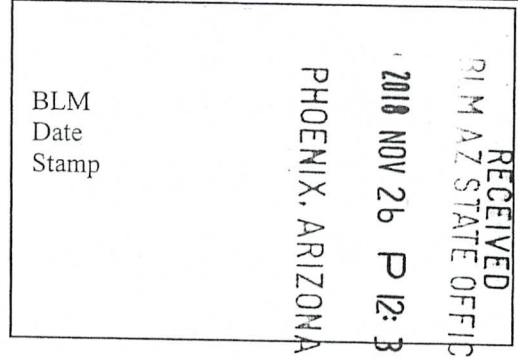

BLM
Date
Stamp

Check here if this is a change of address.

Telephone: 928-303-0554

E-mail Address: mountainstatesmining@gmail.com

I (We) intend to hold the claims(s) and/or site(s) listed below for the calendar year 2019, and I (We) have filed or will file a Notice of Intent to Hold in the county where the claim (s) is located.

Reason for filing a Notice of Intent to Hold instead of an assessment work filing (check one):

- Maintenance fee was paid to maintain claim(s) during this assessment year.
- Mill or tunnel sites.
- Claim(s) was located during the current assessment year.
- BLM has deferred assessment work (attach copy of decision granting deferment, or pending petition for deferment including date petition was filed.)

| Line No. | AMC NUMBER | CLAIM/SITE NAME | COUNTY RECORDER DATA (If available) | TWP | RNG | SEC |
|----------|------------|-----------------|-------------------------------------|-----|-----|-----|
| 1 | 448767 | MSM #01 | | 29N | 17W | 22 |
| 2 | | | | | | |
| 3 | | | | | | |
| 4 | | | | | | |
| 5 | | | | | | |
| 6 | | | | | | |
| 7 | | | | | | |
| 8 | | | | | | |
| 9 | | | | | | |
| 10 | | | | | | |

ENTERED
NOV 30 2018
BY: RAM

ilmazsoIAC



ilmazsoIAC

xdo.pdf

11/26/18 11:02 AM

NOTICE OF INTENTION TO HOLD MINING CLAIMS/SITES

page 2

RECEIVED
 BLM AZ STATE OFFICE
 2018 NOV 26 P 12:33
 PHOENIX, ARIZONA

BLM
 Date
 Stamp

1. State of Arizona, County of MOHAVE

2. I (Name) JACOB MIYAUCHI

3. Reside at (Address) 925 N. COLLEGE AVE #F222

City TEMPE County MARICOPA State AZ Zip 85281 being duly sworn, depose and say that I am a citizen of the United States, more than eighteen years of age, that all of the facts set forth in this notice, subject to the provisions and penalties of 18 U.S.C. 1001 pertaining to the filing of false, fictitious, or fraudulent statements with the United States, are true and correct according to the best of my knowledge, information and belief.

4. Owner's name and address (If not shown in Items 1-3 above).

5. Dated: 11/21/18 Signature: Jacob Miyauchi

Bureau of Land Management
 Arizona State Office
www.blm.gov/az

No. of Claims: 1 x \$10 = 15

Check No: _____ Init. PER

Receipt No.: 4316306

For BLM Use Only

1202162-2-2-2
 castilloe

NOTICE OF INTENTION TO HOLD MINING CLAIMS/SITES

When Recorded Return Document to:

JACOB MIYAUCHI
925 N. COLLEGE AVE # F222
TEMPE, AZ 85281

RECEIVED
 MARICOPA STATE OFFICE
 2018 NOV 26 P 12:33
 PHOENIX, ARIZONA
 BLM
 Date
 Stamp

Check here if this is a change of address.

Telephone: 928-303-0554

E-mail Address: mountainstatesmining@gmail.com

I (We) intend to hold the claims(s) and/or site(s) listed below for the calendar year 20___, and I (We) have filed or will file a Notice of Intent to Hold in the county where the claim (s) is located.

Reason for filing a Notice of Intent to Hold instead of an assessment work filing (check one):

- Maintenance fee was paid to maintain claim(s) during this assessment year.
- Mill or tunnel sites.
- Claim(s) was located during the current assessment year.
- BLM has deferred assessment work (attach copy of decision granting deferment, or pending petition for deferment including date petition was filed.)

| Line No. | AMC NUMBER | CLAIM/SITE NAME | COUNTY RECORDER DATA (If available) | TWP | RNG | SEC |
|----------|------------|-----------------|-------------------------------------|-----|-----|-----|
| 1 | 451341 | MSM #02 | | 50N | 60W | 12 |
| 2 | | | | | | |
| 3 | | | | | | |
| 4 | | | | | | |
| 5 | | | | | | |
| 6 | | | | | | |
| 7 | | | | | | |
| 8 | | | | | | |
| 9 | | | | | | |
| 10 | | | | | | |

NOTICE OF INTENTION TO HOLD MINING CLAIMS/SITES
page 2

RECEIVED
BLM AZ STATE OFFICE
2018 NOV 26 P 12:33
PHOENIX, ARIZONA
BLM
Date
Stamp

1. State of Arizona, County of MARICOPA

2. I (Name) JACOB MIYAUCHI

3. Reside at (Address) 925 N. COLLEGE AVE #F222

City TEMPE County MARICOPA State AZ Zip 85281 being duly sworn, depose and say that I am a citizen of the United States, more than eighteen years of age, that all of the facts set forth in this notice, subject to the provisions and penalties of 18 U.S.C. 1001 pertaining to the filing of false, fictitious, or fraudulent statements with the United States, are true and correct according to the best of my knowledge, information and belief.

4. Owner's name and address (If not shown in Items 1-3 above): _____

5. Dated: 11/21/18 Signature: Jacob Miyauchi

Bureau of Land Management
Arizona State Office
www.blm.gov/az

No. of Claims: 1 x \$10 = 15
Check No: _____ Init. PER
Receipt No.: 4316306
For BLM Use Only

When Recorded Return Document to:

JACOB MIYAUCHI
925 N. COLLEGE AVE. # F222
TEMPE, AZ 85281

OFFICIAL RECORDS OF
MARICOPA COUNTY RECORDER
ADRIAN FONTES
2018-0868942 11/26/18 12:24
PAPER RECORDING

Check here is this is a change of address.

1202162-2-2-1
castilloe

Telephone: 928-303-0554

E-mail address: mountainstatesmining@gmail.com

AFFIDAVIT OF PERFORMANCE OF ANNUAL WORK

1. State of Arizona, County of MARICOPA ss:

2. I (Name) JACOB MIYAUCHI

3. Reside at (Address) 925 N. COLLEGE AVE # F222

City TEMPE County MARICOPA

State AZ zip 85281 being duly sworn, depose and say that I am a citizen of the United States, more than eighteen years of age, and that all of the facts set forth in this affidavit, subject to the provisions and penalties of 18 U.S.C. 1001 pertaining to the filing of false, fictitious, or fraudulent statements with the United States, are true and correct according to the best of my knowledge, information and belief.

4. Owner's name and address (If not shown in Items 1-3 above), _____

5. That I am personally acquainted with the mining claim(s). The work and improvements were made by and at the expense of the owner(s) of said claim(s). Said contiguous group of claims, listed on this document, are situated in the

_____ (optional) Mining District; _____ County, Arizona.

RECEIVED
M ARIZONA STATE OFFICE
2018 NOV 26 P 12:33
PHOENIX, ARIZONA
BLM
Date
Stamp

| Line No. | AMC NUMBER | CLAIM/SITE NAME | COUNTY RECORDER DATA (If available) | TWP | RNG | SEC |
|----------|------------|-----------------|-------------------------------------|-----|-----|-----|
| 1 | 451341 | MSM #02 | | 50N | 60W | 12 |
| 2 | | | | | | |
| 3 | | | | | | |
| 4 | | | | | | |
| 5 | | | | | | |
| 6 | | | | | | |

RECEIVED
 P. M. AZ STATE OFFICE
 2018 NOV 26 P 12:33
 PHOENIX, ARIZONA

BLM
 Date
 Stamp

| | | | | | |
|----|--|--|--|--|--|
| 7 | | | | | |
| 8 | | | | | |
| 9 | | | | | |
| 10 | | | | | |

6. That between the dates starting at 12 o'clock noon on September 1, 20 17 and ending at 12 o'clock noon on September 1, 20 at least \$ 300.00 dollars worth of work and improvements were done and performed upon said claim(s) or upon one or more of a contiguous group of claims for the benefit of all, wholly or partly outside of a contiguous group of claims for the benefit of all, not including the location work.

7. That the following persons were employed to perform the work and improvements described herein: JACOB MIYAUCHI, TERRY MIYAUCHI

8. That the work and improvements performed were: ROAD IMPROVEMENTS

9. Dated: 11/26/18 Signature: Jacob Miyouchi

SUBSCRIBED AND SWORN TO before me, a Notary Public, this 26 day of November 20 18

By: Jacob Miyouchi

Notary Public [Signature]

My Commission Expires 12/14/20

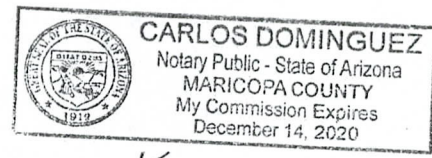

Bureau of Land Management
 Arizona State Office
www.blm.gov/az

No. of Claims: 1 x \$¹⁵10 =
 Check No.: Init. PER
 Receipt No.: 4316306
 For BLM Use Only

JACOB MIYAUCHI

925 N. COLLEGE AVE #F222

TEMPE, AZ 85281



FEE# 2018058116

OFFICIAL RECORDS OF MOHAVE COUNTY KRISTI BLAIR, COUNTY RECORDER



11/23/2018 04:12 PM Fee: \$15.00

PAGE: 1 of 2

Check here is this is a change of address.

Telephone: 928-303-0554

E-mail address: mountainstatesmining@gmail.com

AFFIDAVIT OF PERFORMANCE OF ANNUAL WORK

1. State of Arizona, County of MOHAVE ss:

2. I (Name) JACOB MIYAUCHI

3. Reside at (Address) 925 N. COLLEGE AVE. #F222

City TEMPE County MARICOPA

State AZ Zip 85281 being duly sworn, depose and say that I am a citizen of the United States, more than eighteen years of age, and that all of the facts set forth in this affidavit, subject to the provisions and penalties of 18 U.S.C. 1001 pertaining to the filing of false, fictitious, or fraudulent statements with the United States, are true and correct according to the best of my knowledge, information and belief.

4. Owner's name and address (If not shown in Items 1-3 above).

5. That I am personally acquainted with the mining claim(s). The work and improvements were made by and at the expense of the owner(s) of said claim(s). Said contiguous group of claims, listed on this document, are situated in the

(optional) Mining District; MOHAVE County, Arizona.

RECEIVED BLM AZ STATE OFFICE 2018 NOV 26 P 12: 33 PHOENIX, ARIZONA BLM Date Stamp

Table with 7 columns: Line No., AMC NUMBER, CLAIM/SITE NAME, COUNTY RECORDER DATA (If available), TWP, RNG, SEC. Rows 1-6 with handwritten entries for Au DIGGER and MSM #01.

RECEIVED
BLM AZ STATE OFFICE
2018 NOV 26 P 12:33
PHOENIX, ARIZONA

BLM
Date
Stamp

| | | | | | | |
|----|--|--|--|--|--|--|
| 7 | | | | | | |
| 8 | | | | | | |
| 9 | | | | | | |
| 10 | | | | | | |

6. That between the dates starting at 12 o'clock noon on September 1, 20 17 and ending at 12 o'clock noon on September 1, 20 18 at least \$ 900.00 dollars worth of work and improvements were done and performed upon said claim(s) or upon one or more of a contiguous group of claims for the benefit of all, wholly or partly outside of a contiguous group of claims for the benefit of all, not including the location work.

7. That the following persons were employed to perform the work and improvements described herein: JACOB MIYAUCHI, TERRY MIYAUCHI

8. That the work and improvements performed were: BULK SAMPLING & ROAD IMPROVEMENTS

9. Dated: 11/23/18 Signature: Jacob Miyauchi

SUBSCRIBED AND SWORN TO before me, a Notary Public, this 23rd day of November 20 18

By: Jacob Miyauchi

Notary Public Kelly Nockideneh

My Commission Expires 03-29-2019

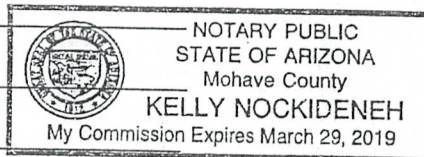

Bureau of Land Management
Arizona State Office
www.blm.gov/az

No. of Claims: 2 x \$15 = _____
 Check No.: _____ Init. PER
 Receipt No.: 4316306
 For BLM Use Only

United States Department of the Interior
Bureau of Land Management
 DIV OF LANDS, MINRLS & ENERGY
 ONE N CENTRAL AVE
 PHOENIX, AZ 85004 -4427
 Phone: 602-417-9200

| | |
|---------|---------|
| Receipt | |
| No. | 4316306 |

Transaction #: 4432748
Date of Transaction: 11/26/2018

CUSTOMER:

JACOB MIYAUCHI
 3408 SOUTHERN VISTA DR
 KINGMAN, AZ 86401-0629 US

| LINE # | QTY | DESCRIPTION | REMARKS | UNIT PRICE | TOTAL |
|---------------|------|--|-----------------|------------|----------------|
| 1 | 1.00 | LOCATABLE MINERALS / MINING CLAIMS- NOT NEW-UNADJUD, ONE AUTH NO. ONLY / MINING CLAIM MONEY RECEIVED CASES: AMC448767/\$75.00 | NOI/2 AND POL/3 | - n/a - | 75.00 |
| TOTAL: | | | | | \$75.00 |

PAYMENT INFORMATION

NOTE: Items will appear on credit card statement as "Bureau of Land Mgmt CO".

| | | | | |
|---|---------------|---|-------------|------------|
| 1 | AMOUNT: | 75.00 | POSTMARKED: | N/A |
| | TYPE: | CREDIT CARD | RECEIVED: | 11/26/2018 |
| | NAME: | MIYAUCHI, JACOB 3408 SOUTHERN VISTA DR KINGMAN AZ 86401-0629 US | | |
| | CARD NO: | XXXXXXXXXXXX8876 | AUTH CODE: | H42095 |
| | NAME ON CARD: | JACOB S MIYAUCHI | | |
| | SIGNATURE: | | | |

REMARKS

This receipt was generated by the automated BLM Collections and Billing System and is a paper representation of a portion of the official electronic record contained therein.

MAINTENANCE FEE WAIVER CERTIFICATION

SEE INSTRUCTIONS ON PAGE 2

FORM APPROVED OMB NO. 1004-0114

Expires: 451341

AMC 426089 448767

496

Handwritten initials

- 1. This small miner waiver is filed for the assessment year beginning on September 1, 2018 and ending on September 1, 2019.
2. The undersigned and all related parties owned ten or fewer mining claims, mill, or tunnel sites located and maintained on Federal lands in the United States of America on September 1, 2018.
3. The undersigned have performed the assessment work required by law for each mining claim listed prior to filing this waiver and understand that by filing this form, the undersigned must file an affidavit of assessment work with the Bureau of Land Management (BLM) by the December 30th following the filing of this waiver.
4. The undersigned understand that if the assessment work obligation has not yet come due under 30 U.S.C. 28 (for those claims in their first assessment year only), a notice of intent to hold reciting this condition must be recorded by the December 30th following the filing of this waiver.
5. The undersigned understand that mill and tunnel sites may also be listed on this waiver and be waived from payment of the maintenance fee, and that a notice of intent to hold for these sites is required to be filed with the BLM by the December 30th following the filing of this waiver.
6. The undersigned understand and acknowledge that pursuant to 43 U.S.C. 1212 and 18 U.S.C. 1001, the filing or recording of a false, fictitious, or fraudulent document with the BLM may result in a fine of up to \$250,000, a prison term not to exceed five years, or both.
7. The mining claims, mill or tunnel sites for which this waiver from payment of the maintenance fees is requested are:

Table with 2 columns: CLAIM OR SITE NAME, BLM RECORDATION SERIAL NUMBER. Rows include Au Digger #1, MSM #01, MSM #02.

RECEIVED BLM AZ STATE OFFICE PHOENIX, ARIZONA 2018 AUG 29 P 2 51

The owner(s) (claimants) of the above mining claims and sites are:

Jacob Miyauchi (Owner's Name - Please Print) 3408 Southern Vista Drive (Owner's Mailing Address)

Jacob Miyauchi (Owner's Signature) Kingman AZ 86401 (City) (State) (Zip Code)

Terence Miyauchi (Owner's Name - Please Print) 3408 Southern Vista Drive (Owner's Mailing Address)

Terence Miyauchi (Owner's Signature) Kingman AZ 86401 (City) (State) (Zip Code)

Kimberly Miyauchi (Owner's Name - Please Print) 3408 Southern Vista Drive (Owner's Mailing Address)

Kimberly Miyauchi (Owner's Signature) Kingman AZ 86401 (City) (State) (Zip Code)

Greg Miyauchi (Owner's Name - Please Print) PO Box 282 (Owner's Mailing Address)

Greg Miyauchi (Owner's Signature) Grand Lake CO 80447 (City) (State) (Zip Code)

(Continued on page 2)

2478483

ENTERED SEP 10 2018 BY: [Signature]

Handwritten initials

Joan Miyauchi

(Owner's Name - Please Print)

Joan Miyauchi

(Owner's Signature)

PO Box 282

(Owner's Mailing Address)

Grand Lake

(City)

CO

(State)

80447

(Zip Code)

Tammy Roussopoulos

(Owner's Name - Please Print)

Tammy Roussopoulos

(Owner's Signature)

2285 N Warwick Ave

(Owner's Mailing Address)

Meridian

(City)

ID

(State)

83646

(Zip Code)

(Owner's Name - Please Print)

(Owner's Signature)

(Owner's Mailing Address)

(City)

(State)

(Zip Code)

(Owner's Name - Please Print)

(Owner's Signature)

(Owner's Mailing Address)

(City)

(State)

(Zip Code)

18 U.S.C. 1001 and 43 U.S.C. 1212 make it a crime for any person knowingly and willfully to make to any department or agency of the United States any false, fictitious or fraudulent statements or representations as to any matter within its jurisdiction.

INSTRUCTIONS

1. This certification is made under the provisions of 43 U.S.C. § 1744 and 30 U.S.C. §28-28k and the regulations thereunder (43 CFR Part 3830).
2. The claimant(s) must fill in the dates in paragraph 1 for the beginning and ending of the assessment year for which this waiver is sought.
3. The claimant(s) must fill in the date in paragraph 2 for the beginning of the assessment year for which this waiver is sought.
4. All claim and site names and BLM serial numbers must be listed for the mining claims, mill sites, and tunnel sites for which the waiver is sought.
5. All owners of the mining claims, mill sites, and tunnel sites and their addresses must be given.
6. This waiver form must be signed by all the claimants or their designated agent, in original form. If an agent is designated, a notarized designation of agent, signed by all of the claimants with proper address given, must be submitted with this waiver.
7. This form must be filed no later than September 1st for the upcoming assessment year in the BLM State Office where the mining claims or sites are recorded, or the waiver cannot be granted by the BLM. (Example: To obtain a waiver for the assessment year 2012, which begins on September 1, 2011, you must qualify for and file for a waiver no later than September 1, 2011, in the proper BLM State Office.)
8. For all mining claims which require assessment work, you must record an affidavit of labor on or before the December 30th immediately following the filing of this waiver. For all other mining claims or sites waived, you must record a notice of intent to hold on or before the December 30th immediately following the filing of this waiver.
9. Mill and tunnel sites may also be listed on this waiver and be waived from payment of the maintenance fee. A notice of intent to hold for these sites is required to be filed by the December 30th following the filing of this waiver.

PHOENIX, ARIZONA
 2016 AUG 29 P 2:51
 RECEIVED
 BLM STATE OFFICE
 FOR OFFICIAL USE ONLY

JACOB MIYAUCHI
3408 SOUTHERN VISTA DRIVE
KINGMAN, AZ 86401

CERTIFIED MAIL®



7016 0910 0001 7619 2156

BUREAU OF LAND MANAGEMENT
1 N CENTRAL AVE SUITE 800
PHOENIX, AZ 85004

\$3.92⁰
US POSTAGE
FIRST-CLASS

071S00917385
85281



RECEIVED
BLM AZ STATE OFFICE
2018 AUG 29 P 2:51
PHOENIX, ARIZONA

9500484497 0041



2. Type of labor and improvements (specify what was done and give the total value for that labor and improvement to show at least \$100 for each claim). If a geological, geochemical, or geophysical survey was performed, as per 30 U.S.C. 28-1, reference the title of the report of survey, give cost and date of the survey and report, and indicate it was filed with the County Recorder:

| Description of Work Performed | Value of Work Performed | Date Work Was Performed |
|-------------------------------|-------------------------|----------------------------|
| BULKSAMPLING OF PROSPECT PITS | \$300.00 | DEC 1, 2016 - MAY 10, 2017 |
| | | |
| | | |
| | | |

3. Name and mailing address of each person who performed the labor and improvements:

Name (please print)

TERRY MIYAUCHI
JACOB MIYAUCHI

Current Mailing Address (please print)

3408 SOUTHERN VISTA DRIVE KINGMAN AZ 86401
3408 SOUTHERN VISTA DRIVE KINGMAN AZ 86401

4. Name and mailing address of each person who holds and claims the subject mining claim(s) for the valuable minerals contained therein. Be sure to indicate if there is a change of address:

Name (please print)

TERRY MIYAUCHI

Current Mailing Address (please print)

3408 SOUTHERN VISTA DRIVE

RECEIVED
 DEPARTMENT OF REVENUE
 2018 JAN - 4 P 12: 56
 PHOENIX, ARIZONA

5. The undersigned testifies that on the date of August 28, 2017, all monuments required by law were erected upon the subject claim(s), and all notices required by law were posted on the subject claim(s) or copies thereof were in place, and at said date, each corner monument bore or contained

markings sufficient to appropriately designate the corner of the claim to which it pertains and the name of the claim(s).

I hereby certify under penalty of perjury under the laws of the State of ARIZONA that the foregoing statements are true and correct:

[Signature] Date: 12-11-17
(Signature of person responsible for above statement)

Title 18 U.S.C. 1001 and 43 U.S.C. 1212 make it a crime for any person knowingly and willfully to make to any department or agency of the United States any false, fictitious or fraudulent statements or representations as to any matter within its jurisdiction.

Notary Block

SUBSCRIBED AND SWORN TO before me, this 11 day of December 20 17

By: [Signature]
(Signature of Affiant)

Title: Notary Public

My Commission Expires: 02/10/2021

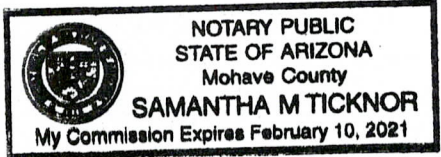

INSTRUCTIONS

- 1. This is an optional form that may be used to satisfy the requirements for the Bureau of Land Management (BLM) under the provisions of 43 U.S.C. §1744 and 30 U.S.C. §28-28d and the regulations thereunder (43 CFR part 3835). Since local and State laws may vary, you should contact your local and State agencies where the claims are located to ensure all applicable laws and requirements are satisfied.
- 2. The claimant(s) must fill in the date in paragraph 1 for the applicable assessment year and the county and state where the claims are located.
- 3. All claim names, BLM serial numbers, legal descriptions, and original county recording information must be listed for the claims pertaining to this assessment notice.
- 4. The claimant(s) must complete paragraph 2 listing all labor or improvements which was performed on or did benefit the subject mining claims. The value and date of the labor or improvements must also be listed. The total amount of labor or improvements can be listed, but the total expenditure must equal at least \$100 for each claim.
- 5. The names and current mailing addresses of the person(s) performing the labor shall be listed in paragraph 3.
- 6. The name and current mailing address of each owner (claimant) of the claims shall be listed in paragraph 4. The mailing address shall be the owner's address and not the address of an agent or anyone representing the claimant. Be sure to note if there has been a change of address.
- 7. Paragraph 5 shall be completed to show the date it was verified that all monuments required by law were properly erected, all notices were posted, and that corners were appropriately designated for all claims listed.
- 8. An exact legible reproduction or duplicate (other than microfilm or other electronic media) of this affidavit or another type of affidavit of assessment work that you file or will file in the county where each claim is located, must be filed with the BLM on or before December 30 of the calendar year in which the assessment year ends. For mill or tunnel sites, a separate notice of intent to hold must be filed with the BLM on or before December 30. Requirements for filing a notice of intent to hold can be found at 43 CFR 3835.33.
- 9. A processing fee of \$10 for each claim listed must be remitted to the BLM along with this or any other affidavit of assessment work.

RECEIVED
NOV 14 2017
BLM
MILTON
ARIZONA
12:50 PM

December 26, 2017

Bureau of Land Management
One North Central Ave., STE. 800
Arizona State Office
Phoenix, AZ 85004-4427

To whom it may concern,

Attached is form 1004-0114 Affidavit of Annual Assessment Work and form MCF102 Location Notice for Placer Mining Claim. Two processing fees have also been attached, on for the Affidavit(\$10) and one for the Location Notice(\$987). If any additional information or corrections are needed please contact me at:

Phone: 928-303-0554

Email: mountatinstatesmining@gmail.com

Address: 3408 Southern Vista Drive, Kingman, AZ, 86401

Jacob Miyauchi

RECEIVED
BLM ARIZONA STATE OFFICE
2018 JAN -4 P 12:55
PHOENIX, ARIZONA

United States Department of the Interior
Bureau of Land Management
 DIV OF LANDS, MINRLS & ENERGY
 ONE N CENTRAL AVE
 PHOENIX, AZ 85004 -4427
 Phone: 602-417-9200

Receipt

No: 4061402

| | |
|---|--|
| Transaction #: 4173034 | |
| Date of Transaction: 01/08/2018 | |
| CUSTOMER: | |
| TERENCE MIYAUCHI 3408 SOUTHERN VISTA DR KINGMAN, AZ 86401-0629 US | |

| LINE # | QTY | DESCRIPTION | REMARKS | UNIT PRICE | TOTAL |
|---------------|------|--|------------|------------|----------------|
| 1 | 1.00 | LOCATABLE MINERALS / MINING CLAIMS- NOT NEW-UNADJUD, ONE AUTH NO. ONLY / MINING CLAIM MONEY RECEIVED CASES: AMC426089/\$10.00 | POL 2017/1 | - n/a - | 10.00 |
| TOTAL: | | | | | \$10.00 |

| PAYMENT INFORMATION | | | |
|---------------------|-----------|---|----------------------|
| 1 | AMOUNT: | 10.00 | POSTMARKED: N/A |
| | TYPE: | CHECK | RECEIVED: 01/04/2018 |
| | CHECK NO: | 104 | |
| | NAME: | MIYAUCHI, TERENCE 3408 SOUTHERN VISTA DR KINGMAN AZ 86401-0629 US | |

| REMARKS |
|---|
| <i>Envelope is with the mining claim - full</i> |

This receipt was generated by the automated BLM Collections and Billing System and is a paper representation of a portion of the official electronic record contained therein.

Amc 426089

425

TR

Form 3830-2
()

UNITED STATES
DEPARTMENT OF THE INTERIOR
BUREAU OF LAND MANAGEMENT
MAINTENANCE FEE WAIVER CERTIFICATION

FORM APPROVED
OMB NO. 1004-0114
Expires:

SEE INSTRUCTIONS ON PAGE 2

1. This small miner waiver is filed for the assessment year beginning on September 1, 2017 and ending on September 1, 2018.
2. The undersigned and all related parties owned ten or fewer mining claims, mill, or tunnel sites located and maintained on Federal lands in the United States of America on September 1, 2017.
3. The undersigned have performed the assessment work required by law for each mining claim listed prior to filing this waiver and understand that by filing this form, the undersigned must file an affidavit of assessment work with the Bureau of Land Management (BLM) by the December 30th following the filing of this waiver.
4. The undersigned understand that if the assessment work obligation has not yet come due under 30 U.S.C. 28 (for those claims in their first assessment year only), a notice of intent to hold reciting this condition must be recorded by the December 30th following the filing of this waiver.
5. The undersigned understand that mill and tunnel sites may also be listed on this waiver and be waived from payment of the maintenance fee, and that a notice of intent to hold for these sites is required to be filed with the BLM by the December 30th following the filing of this waiver.
6. The undersigned understand and acknowledge that pursuant to 43 U.S.C. 1212 and 18 U.S.C. 1001, the filing or recording of a false, fictitious, or fraudulent document with the BLM may result in a fine of up to \$250,000, a prison term not to exceed five years, or both.
7. The mining claims, mill or tunnel sites for which this waiver from payment of the maintenance fees is requested are:

| CLAIM OR SITE NAME | BLM RECORDATION SERIAL NUMBER |
|--------------------|-------------------------------|
| 1. AU DIGGER #1 | ✓ AMC 426089 |
| 2. | |
| 3. | |
| 4. | |
| 5. | |
| 6. | |
| 7. | |
| 8. | |
| 9. | |
| 10. | |

The owner(s) (claimants) of the above mining claims and sites are:

TERENCE S. MIYAUCHI
(Owner's Name - Please Print)
3408 SOUTHERN VISTA DRIVE
(Owner's Mailing Address)

[Signature]
(Owner's Signature)
KINGMAN AZ 86461
(City) (State) (Zip Code)

(Owner's Name - Please Print)

(Owner's Mailing Address)

(Owner's Signature)

(City) (State) (Zip Code)

(Owner's Name - Please Print)

(Owner's Mailing Address)

(Owner's Signature)

(City) (State) (Zip Code)

(Owner's Name - Please Print)

(Owner's Mailing Address)

(Owner's Signature)

(City) (State) (Zip Code)

(Continued on page 2)

ENTERED
SEP 14 2017
BY: [Signature]

RECEIVED
BLM STATE OFFICE
PHOENIX, ARIZONA
2017 AUG 29 A 11:59

AW

| | | | |
|-------------------------------|---------------------|---------|------------|
| (Owner's Name - Please Print) | (Owner's Signature) | | |
| (Owner's Mailing Address) | (City) | (State) | (Zip Code) |
| | | | |
| (Owner's Name - Please Print) | (Owner's Signature) | | |
| (Owner's Mailing Address) | (City) | (State) | (Zip Code) |
| | | | |
| (Owner's Name - Please Print) | (Owner's Signature) | | |
| (Owner's Mailing Address) | (City) | (State) | (Zip Code) |
| | | | |
| (Owner's Name - Please Print) | (Owner's Signature) | | |
| (Owner's Mailing Address) | (City) | (State) | (Zip Code) |

18 U.S.C. 1001 and 43 U.S.C. 1212 make it a crime for any person knowingly and willfully to make to any department or agency of the United States any false, fictitious or fraudulent statements or representations as to any matter within its jurisdiction.

INSTRUCTIONS

1. This certification is made under the provisions of 43 U.S.C. § 1744 and 30 U.S.C. §28-28k and the regulations thereunder (43 CFR Part 3830).
2. The claimant(s) must fill in the dates in paragraph 1 for the beginning and ending of the assessment year for which this waiver is sought.
3. The claimant(s) must fill in the date in paragraph 2 for the beginning of the assessment year for which this waiver is sought.
4. All claim and site names and BLM serial numbers must be listed for the mining claims, mill sites, and tunnel sites for which the waiver is sought.
5. All owners of the mining claims, mill sites, and tunnel sites and their addresses must be given.
6. This waiver form must be signed by all the claimants or their designated agent, in original form. If an agent is designated, a notarized designation of agent, signed by all of the claimants with proper address given, must be submitted with this waiver.
7. This form must be filed no later than September 1st for the upcoming assessment year in the BLM State Office where the mining claims or sites are recorded, or the waiver cannot be granted by the BLM. (Example: To obtain a waiver for the assessment year 2012, which begins on September 1, 2011, you must qualify for and file for a waiver no later than September 1, 2011, in the proper BLM State Office.)
8. For all mining claims which require assessment work, you must record an affidavit of labor on or before the December 30th immediately following the filing of this waiver. For all other mining claims or sites waived, you must record a notice of intent to hold on or before the December 30th immediately following the filing of this waiver.
9. Mill and tunnel sites may also be listed on this waiver and be waived from payment of the maintenance fee. A notice of intent to hold for these sites is required to be filed by the December 30th following the filing of this waiver.

RECEIVED
 BLM STATE OFFICE
 2011 AUG 29 A 11: 59
 PHOENIX, ARIZONA

FOR OFFICIAL USE ONLY

NOTICES

The Privacy Act and 43 CFR 2. (d) require that you be furnished the following information in connection with the information requested by this form.

AUTHORITY: 30 U.S.C. 28f and 43 CFR part 3835 permit collection of the information requested by this form.

PRINCIPAL PURPOSE: The BLM will use the information you provide to verify that the owner(s) (claimants(s)) of a mining claim has/have complied with 30 U.S.C. 28f and 43 CFR part 3835 and is/are entitled to perform assessment work in lieu of paying the maintenance fee for the mining claims listed on this form.

ROUTINE USES: The BLM will only disclose this information in accordance with the provisions at 43 CFR 2. (b) and (c).

EFFECT OF NOT PROVIDING INFORMATION: Disclosure of the requested information is required by 30 U.S.C. 28f and 43 CFR part 3835 for those claimants qualified to request the small miner waiver allowed. Failure to submit all the requested information or to complete this form will delay the BLM's processing of the form and may preclude the BLM's acceptance of the maintenance fee waiver request, which may result in forfeiture of the mining claim or site by the claimant.

The Paperwork Reduction Act requires us to inform you that:

The BLM collects this information to determine whether or not you are qualified for waiver of maintenance fees.

Submission of the requested information is necessary to obtain or retain a benefit.

You do not have to respond to this or any other Federal agency-sponsored information collection unless it displays a currently valid OMB control number.

BURDEN HOURS STATEMENT: Public reporting burden for this form is estimated to average 20 minutes per response, including the time for reviewing instructions, gathering and maintaining data, and completing and reviewing the form. You may submit comments regarding the burden estimate or any other aspect of this form to: U.S. Department of the Interior, Bureau of Land Management (1004-0114), Bureau Information Collection Clearance Officer (WO-630), Mail Stop 401 LS, 1849 C St., N.W., Washington, D.C. 20240.

RECEIVED
BLM AZ STATE OFFICE
2011 AUG 29 11:59
PHOENIX, ARIZONA

UNITED STATES
DEPARTMENT OF THE INTERIOR
BUREAU OF LAND MANAGEMENT
MAINTENANCE FEE WAIVER CERTIFICATION

595

FORM APPROVED
OMB NO. 1004-0114
Expires: October 31, 2016

SEE INSTRUCTIONS ON PAGE 2

426089

- This small miner waiver is filed for the assessment year beginning on September 1, 2016 and ending on September 1, 2017.
- The undersigned and all related parties owned ten or fewer mining claims, mill, or tunnel sites located and maintained on Federal lands in the United States of America on September 1, 2016.
- The undersigned have performed the assessment work required by law for each mining claim listed prior to filing this waiver and understand that by filing this form, the undersigned must file an affidavit of assessment work with the Bureau of Land Management (BLM) by the December 30th following the filing of this waiver.
- The undersigned understand that if the assessment work obligation has not yet come due under 30 U.S.C. 28 (for those claims in their first assessment year only), a notice of intent to hold reciting this condition must be recorded by the December 30th following the filing of this waiver.
- The undersigned understand that mill and tunnel sites may also be listed on this waiver and be waived from payment of the maintenance fee, and that a notice of intent to hold for these sites is required to be filed with the BLM by the December 30th following the filing of this waiver.
- The undersigned understand and acknowledge that pursuant to 43 U.S.C. 1212 and 18 U.S.C. 1001, the filing or recording of a false, fictitious, or fraudulent document with the BLM may result in a fine of up to \$250,000, a prison term not to exceed five years, or both.
- The mining claims, mill or tunnel sites for which this waiver from payment of the maintenance fees is requested are:

| CLAIM OR SITE NAME | BLM RECORDATION SERIAL NUMBER |
|--------------------|-------------------------------|
| 1. AU DIGGER #1 | AMC 426089 ✓ |
| 2. | |
| 3. | |
| 4. | |
| 5. | |
| 6. | |
| 7. | |
| 8. | |
| 9. | |
| 10. | |

RECEIVED
BLM AZ STATE OFFICE
2016 SEP - 1 P 3:25
PHOENIX, ARIZONA

The owner(s) (claimants) of the above mining claims and sites are:

TERENCE S. MIYAUCHI
 (Owner's Name - Please Print)
 3408 SOUTHERN VISTA DR
 (Owner's Mailing Address)

Terence S. Miyauchi
 (Owner's Signature)
 KINGMAN AZ 86401
 (City) (State) (Zip Code)

 (Owner's Name - Please Print)

 (Owner's Mailing Address)

 (Owner's Signature)
 _____ (City) _____ (State) _____ (Zip Code)

 (Owner's Name - Please Print)

 (Owner's Mailing Address)

 (Owner's Signature)
 _____ (City) _____ (State) _____ (Zip Code)

 (Owner's Name - Please Print)

 (Owner's Mailing Address)

 (Owner's Signature)
 _____ (City) _____ (State) _____ (Zip Code)

ENTERED
 483
 SEP 08 2016
 BY: *[Signature]*

NWJ

(Owner's Name - Please Print)

(Owner's Signature)

(Owner's Mailing Address)

(City) RECEIVED BLM AZ STATE OFFICE (State) (Zip Code)

(Owner's Name - Please Print)

2016 SEP -1 P 3:25 (Owner's Signature)

(Owner's Mailing Address)

PHOENIX, ARIZONA (City) (State) (Zip Code)

(Owner's Name - Please Print)

(Owner's Signature)

(Owner's Mailing Address)

(City) (State) (Zip Code)

(Owner's Name - Please Print)

(Owner's Signature)

(Owner's Mailing Address)

(City) (State) (Zip Code)

18 U.S.C. 1001 and 43 U.S.C. 1212 make it a crime for any person knowingly and willfully to make to any department or agency of the United States any false, fictitious or fraudulent statements or representations as to any matter within its jurisdiction.

INSTRUCTIONS

1. This certification is made under the provisions of 43 U.S.C. § 1744 and 30 U.S.C. §28-28k and the regulations thereunder (43 CFR Part 3830).
2. The claimant(s) must fill in the dates in paragraph 1 for the beginning and ending of the assessment year for which this waiver is sought.
3. The claimant(s) must fill in the date in paragraph 2 for the beginning of the assessment year for which this waiver is sought.
4. All claim and site names and BLM serial numbers must be listed for the mining claims, mill sites, and tunnel sites for which the waiver is sought.
5. All owners of the mining claims, mill sites, and tunnel sites and their addresses must be given.
6. This waiver form must be signed by all the claimants or their designated agent, in original form. If an agent is designated, a notarized designation of agent, signed by all of the claimants with proper address given, must be submitted with this waiver.
7. This form must be filed no later than September 1st for the upcoming assessment year in the BLM State Office where the mining claims or sites are recorded, or the waiver cannot be granted by the BLM. (Example: To obtain a waiver for the assessment year 2012, which begins on September 1, 2011, you must qualify for and file for a waiver no later than September 1, 2011, in the proper BLM State Office.)
8. For all mining claims which require assessment work, you must record an affidavit of labor on or before the December 30th immediately following the filing of this waiver. For all other mining claims or sites waived, you must record a notice of intent to hold on or before the December 30th immediately following the filing of this waiver.
9. Mill and tunnel sites may also be listed on this waiver and be waived from payment of the maintenance fee. A notice of intent to hold for these sites is required to be filed by the December 30th following the filing of this waiver.

FOR OFFICIAL USE ONLY

NOTICES

The Privacy Act and 43 CFR 2.48(d) require that you be furnished the following information in connection with the information requested by this form.

AUTHORITY: 30 U.S.C. 28f and 43 CFR part 3835 permit collection of the information requested by this form.

PRINCIPAL PURPOSE: The BLM will use the information you provide to verify that the owner(s) (claimants(s)) of a mining claim has/have complied with 30 U.S.C. 28f and 43 CFR part 3835 and is/are entitled to perform assessment work in lieu of paying the maintenance fee for the mining claims listed on this form.

ROUTINE USES: The BLM will only disclose this information in accordance with the provisions at 43 CFR 2.56(b) and (c).

EFFECT OF NOT PROVIDING INFORMATION: Disclosure of the requested information is required by 30 U.S.C. 28f and 43 CFR part 3835 for those claimants qualified to request the small miner waiver allowed. Failure to submit all the requested information or to complete this form will delay the BLM's processing of the form and may preclude the BLM's acceptance of the maintenance fee waiver request, which may result in forfeiture of the mining claim or site by the claimant.

The Paperwork Reduction Act requires us to inform you that:

The BLM collects this information to determine whether or not you are qualified for waiver of maintenance fees.

Submission of the requested information is necessary to obtain or retain a benefit.

You do not have to respond to this or any other Federal agency-sponsored information collection unless it displays a currently valid OMB control number.

BURDEN HOURS STATEMENT: Public reporting burden for this form is estimated to average 20 minutes per response, including the time for reviewing instructions, gathering and maintaining data, and completing and reviewing the form. You may submit comments regarding the burden estimate or any other aspect of this form to: U.S. Department of the Interior, Bureau of Land Management (1004-0114), Bureau Information Collection Clearance Officer (WO-630), Mail Stop 401 LS, 1849 C St., N.W., Washington, D.C. 20240.

RECEIVED
BLM AZ STATE OFFICE
2016 SEP - 1 P 3:25
PHOENIX, ARIZONA

3

AFFIDAVIT OF ANNUAL ASSESSMENT WORK

426089

WHEN RECORDED, MAIL DOCUMENT TO:

NAME: TERENCE MIYAUCHI

ADDRESS: 3408 SOUTHERN VISTA DRIVE

CITY, STATE, ZIP: KINGMAN AZ 86401

FEE# 2016038490

OFFICIAL RECORDS
OF MOHAVE COUNTY
ROBERT BALLARD,
COUNTY RECORDER



08/26/2016 02:09 PM Fee: \$15.00

PAGE: 1 of 3

FOR COUNTY RECORDER'S USE

No. of Claims 1

x \$10/claim

Total due BLM \$ 10,00

TO ALL WHOM IT MAY CONCERN:

1. The undersigned certifies that at least \$100 per claim was expended for development, labor and improvements, or equivalent value added, as the annual assessment work for the assessment year ending September 1, 2016 for the following contiguous unpatented mining claim(s), located in the County of MOHAVE, in the State of ARIZONA.

| BLM Serial No. | Name of Claim | Tp Rg Sec Mer | | | | County Recordation Book and Page No. | Date |
|----------------|---------------|------------------------|-----|----|----|---|------|
| | | Example: 13N 5E 14 MDM | | | | | |
| AMC 426089 | AU DIGGER #1 | 29N | 17W | 22 | 14 | | |
| | | | | | | | |
| | | | | | | | |
| | | | | | | | |
| | | | | | | | |
| | | | | | | | |
| | | | | | | | |
| | | | | | | | |
| | | | | | | | |

RECEIVED
BLM AZ STATE OFFICE
2016 SEP - 1 P 3:24
PHOENIX, ARIZONA

2. Type of labor and improvements (specify what was done and give the total value for that labor and improvement to show at least \$100 for each claim). If a geological, geochemical, or geophysical survey was performed, as per 30 U.S.C. 28-1, reference the title of the report of survey, give cost and date of the survey and report, and indicate it was filed with the County Recorder:

| Description of Work Performed | Value of Work Performed | Date Work Was Performed |
|--------------------------------|-------------------------|---------------------------|
| BULK SAMPLING OF PROSPECT PITS | \$250.00 | DEC 1 2015 - MAY 10, 2016 |
| | | |
| | | |
| | | |

3. Name and mailing address of each person who performed the labor and improvements:

Name (please print)

TERRY MIYAUCHI
 JACOB MIYAUCHI

Current Mailing Address (please print)

3408 SOUTHERN VISTA DR, KINGMAN, AZ 86401
 3408 SOUTHERN VISTA DR, KINGMAN, AZ 86401

4. Name and mailing address of each person who holds and claims the subject mining claim(s) for the valuable minerals contained therein. Be sure to indicate if there is a change of address:

Name (please print)

TERRY MIYAUCHI

Current Mailing Address (please print)

3408 SOUTHERN VISTA DR, KINGMAN, AZ 86401

RECEIVED
 BLM AZ STATE OFFICE
 2016 SEP - 1 P 3:24
 PHOENIX, ARIZONA

5. The undersigned testifies that on the date of AUGUST 17, 2016, all monuments required by law were erected upon the subject claim(s), and all notices required by law were posted on the subject claim(s) or copies thereof were in place, and at said date, each corner monument bore or contained

markings sufficient to appropriately designate the corner of the claim to which it pertains and the name of the claim(s).

I hereby certify under penalty of perjury under the laws of the State of ARIZONA that the foregoing statements are true and correct:

J. J. Miyama Date: 8/19/16
(Signature of person responsible for above statement)

Title 18 U.S.C. 1001 and 43 U.S.C. 1212 make it a crime for any person knowingly and willfully to make to any department or agency of the United States any false, fictitious or fraudulent statements or representations as to any matter within its jurisdiction.

Notary Block

SUBSCRIBED AND SWORN TO before me, this 19th day of August 2016

By: TERENCE SCOTT MIYAUCHI
(Signature of Affiant)

Title: Jasjit Singh NOTARY

My Commission Expires: Feb 23, 2020

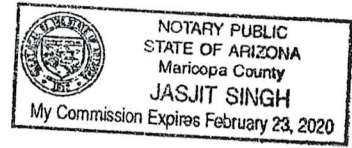

INSTRUCTIONS

1. This is an optional form that may be used to satisfy the requirements for the Bureau of Land Management (BLM) under the provisions of 43 U.S.C. §1744 and 30 U.S.C. §28-28d and the regulations thereunder (43 CFR part 3835). Since local and State laws may vary, you should contact your local and State agencies where the claims are located to ensure all applicable laws and requirements are satisfied.
2. The claimant(s) must fill in the date in paragraph 1 for the applicable assessment year and the county and state where the claims are located.
3. All claim names, BLM serial numbers, legal descriptions, and original county recording information must be listed for the claims pertaining to this assessment notice.
4. The claimant(s) must complete paragraph 2 listing all labor or improvements which was performed on or did benefit the subject mining claims. The value and date of the labor or improvements must also be listed. The total amount of labor or improvements can be listed, but the total expenditure must equal at least \$100 for each claim.
5. The names and current mailing addresses of the person(s) performing the labor shall be listed in paragraph 3.
6. The name and current mailing address of each owner (claimant) of the claims shall be listed in paragraph 4. The mailing address shall be the owner's address and not the address of an agent or anyone representing the claimant. Be sure to note if there has been a change of address.
7. Paragraph 5 shall be completed to show the date it was verified that all monuments required by law were properly erected, all notices were posted, and that corners were appropriately designated for all claims listed.
8. An exact legible reproduction or duplicate (other than microfilm or other electronic media) of this affidavit or another type of affidavit of assessment work that you file or will file in the county where each claim is located, must be filed with the BLM on or before December 30 of the calendar year in which the assessment year ends. For mill or tunnel sites, a separate notice of intent to hold must be filed with the BLM on or before December 30. Requirements for filing a notice of intent to hold can be found at 43 CFR 3835.33.
9. A processing fee of \$10 for each claim listed must be remitted to the BLM along with this or any other affidavit of assessment work.

NOTICES

THE PRIVACY ACT and 43 CFR 2.48(d) require that you be furnished with the following information in connection with the information requested by this form.

AUTHORITY: 30 U.S.C. §28-28d and 43 CFR part 3835 permit collection of the information requested by this form.

PRINCIPAL PURPOSE: The BLM will use the information you provide to document compliance with 43 U.S.C. 1744 and that assessment work has been completed in accordance with 30 U.S.C. § 28-28d and 43 CFR part 3835 in lieu of paying the maintenance fee for the mining claims listed on this form.

ROUTINE USES: The BLM will only disclose this information in accordance with the provisions at 43 CFR 2.56(b) and (c).

EFFECT OF NOT PROVIDING INFORMATION: Disclosure of the requested information is required by 30 U.S.C. § 28-28d and 43 CFR part 3835 for claimants qualified to perform assessment work in lieu of paying the maintenance fee. Failure to submit all the requested information or to complete this form will delay the BLM's processing of the form and may preclude the BLM's acceptance of the assessment work information, which may result in forfeiture of the mining claim(s) by the claimant.

THE PAPERWORK REDUCTION ACT requires us to inform you that:

Use of this form is optional. You must perform assessment if a waiver to pay the maintenance fee has been requested. This form is provided to help you attest that annual assessment work has been completed in lieu of paying the maintenance fee for your claim(s). Submission of the requested information is necessary to obtain or retain a benefit.

You do not have to respond to this or any other Federal agency-sponsored information collection unless it displays a valid OMB control number.

BURDEN HOURS STATEMENT: The estimated public reporting burden for this form is 30 minutes per response, including the time for reviewing instructions, gathering and maintaining data, and completing and reviewing the form. You may submit comments regarding the burden estimate or any other aspect of this form to: U.S. Department of the Interior, Bureau of Land Management (1004-0114), Bureau Information Collection Clearance Officer (WO-630), 1849 C Street, N.W., Room 2134LM, Washington, D.C. 20240.

RECEIVED
BLM AZ STATE OFFICE
2016 SEP -1 P 3:25
PHOENIX, ARIZONA

MIYAUCHI
3408 SOUTHERN VISTA DRIVE
KINGMAN, AZ 86401
UNITED STATES

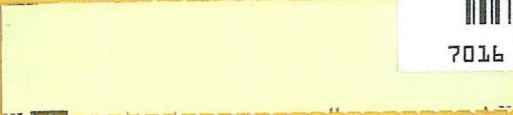
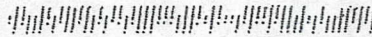

BLM ARIZONA STATE OFFICE
ONE NORTH CENTRAL AVENUE → SUITE 800
PHOENIX, AZ 85004-4427

RECEIVED
BLM AZ STATE OFFICE
2016 SEP - 1 P 3:24
PHOENIX, ARIZONA

RETURN RECEIPT
REQUESTED



7016

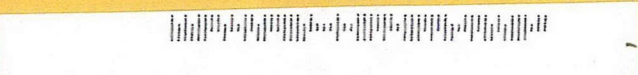

MINING CLAIM RENEWAL

**DEPARTMENT OF THE INTERIOR
BUREAU OF LAND MANAGEMENT
MINING CLAIMS**

Run Date/Time: 09/02/2016 11:21 AM

(LIVE) Serial Register Page

Page 1 of 1

01.10-21-1976;090STAT0090;43USC1744
Case Type 384201: PLACER CLAIM
Claim Name: AU DIGGER
Commodity :
Case Disposition: ACTIVE
Required Maintenance Fee: \$155.00

Total Acres
20.000

Serial Number
AMC426089
Lead File Number
AMC426089

| Name & Address | Int Rel |
|--|----------|
| MIYAUCHI TERRY 3408 SOUTHERN VISTA DR KINGMAN, AZ 86401-0629 | CLAIMANT |

| Mer Twp | Rng | Sec | Quadrant | District/Field Office | County |
|---------|-------|-------|----------|-----------------------|--------|
| 14 | 0290N | 0170W | 022 SW | KINGMAN FO | MOHAVE |

| Act Date | Code | Action | Action Remarks | Receipt Number |
|------------|------|-----------------------------|----------------|----------------|
| 12/23/2013 | 403 | LOCATION DATE | | |
| 12/30/2013 | 395 | RECORDATION NOTICE RECD | 1 | 2942589 |
| 08/19/2015 | 483 | SMALL MINER CERT FILED | 2016 | |
| 08/19/2015 | 480 | EVID OF ASSMT FILED | 2015 | 3371357 |
| 08/27/2014 | 483 | SMALL MINER CERT FILED | 2015 | |
| 12/30/2013 | 484 | LOCATION YEAR / MAINTENANCE | 2014;\$140 | 2942589 |
| 08/27/2014 | 481 | NOTICE OF INTENT TO HOLD | 2014 | 3115253 |
| 06/02/2014 | 669 | LAND STATUS CHECKED | | |
| 12/30/2013 | 501 | ACCT ADV IN LEAD FILE | AMC426089; | |
| 12/23/2013 | 404 | COUNTY RECORDATION | 2013063572; | |

Line Nr Remarks

Order Detail

[Close](#)

Transaction ID 3469531
 Order Type A
 Order Status P
 Order Date 08/19/2015
 Login ID 2994
 Login egong

Receive Date 08/19/2015
 Receipt ID 3371357
 Reference Transaction
 Last Updated By 2994
 Last Update User egong
 Last Update Date 8/19/15 16:42

Customer ID
 First Name TERRANCE
 Middle Initial
 Last Name MIYAUCHI
 Company

Address 1 3408 SOUTHERN VISTA DR
 Address 2
 City KINGMAN State AZ Zip -
 Country US
 Phone 928.279.2274

*I called 11:25 AM
 9-2-16
 Need to pay \$10 cc for POL
 I left a message.*

Assignor ID
 First Name
 Middle Initial
 Last Name
 Company
 AR flag

Historical Order Number

Order Items

| OITranID | XferOI | OrderID | Login | OI-Date | Type | Qty | UnitPrice | Total | BillNumber | BillLine | BIID | CostCtr |
|----------|---------|---------|----------|------------|------|------|-----------|--------|------------|----------|------|--------------|
| 17345255 | | 3469531 | egong | 08/19/2015 | C | 1.00 | 0.00 | 10.00 | | | | LLAZ931000LL |
| 27351253 | 7345255 | 3469531 | LR2KMCII | 08/21/2015 | T | 1.00 | 0.00 | -10.00 | | | | LLAZ931000LL |
| 37351254 | 7351253 | 3469531 | LR2KMCII | 08/21/2015 | T | 1.00 | 10.00 | 10.00 | | | | LLAZ950000LL |

UNITED STATES
DEPARTMENT OF THE INTERIOR
BUREAU OF LAND MANAGEMENT

CREDIT CARD PAYMENT

For

Affidavit of PERFORMANCE of WORK

THIS IS A CHANGE OF ADDRESS

TELEPHONE SUBMISSION - ACCURACY OF THE BELOW INFORMATION IS THE RESPONSIBILITY OF THE CLAIMANT/OWNER

NAME Terence MIYAUCHI
ADDRESS 3408 Southern Vista Dr
CITY Kingman STATE AZ ZIP 86401
PHONE # 928 - 279-2274

SEND RECEIPT TO Above address
 Other (Include Name and Mailing Address):

AMC NUMBER
426 089

CLAIM/SITE NAME
AU DIGGER

1 # of Claim/Site
x 155.00 Each
\$ 10.00 Total Charged BJ (INITIALS)

RECEIPT # 3652273

DATE STAMP

RECEIVED
BLM AZ STATE OFFICE
2016 SEP - 6 A 11: 21
PHOENIX, ARIZONA

***** FOR OFFICIAL USE ONLY *****

DATE _____ INITIALS _____ VERIFIED _____

**United States Department of the Interior
Bureau of Land Management**
DIV OF LANDS, MINRLS & ENERGY
ONE N CENTRAL AVE
PHOENIX, AZ 85004 -4427
Phone: 602-417-9200

Receipt

No: 3652273

| | |
|---|--|
| Transaction #: 3756313 | |
| Date of Transaction: 09/06/2016 | |
| CUSTOMER: | |
| TERENCE MIYAUCHI 3408 SOUTHERN VISTA DR KINGMAN, AZ 86401-0629 US | |

| LINE # | QTY | DESCRIPTION | REMARKS | UNIT PRICE | TOTAL |
|---------------|------|---|--------------|------------|----------------|
| 1 | 1.00 | LOCATABLE MINERALS / MINING CLAIMS- NOT NEW-UNADJUD, ONE AUTH NO. ONLY / MINING CLAIM MONEY RECEIVED CASES: AMC426089/\$10.00 | 2016 POL (1) | - n/a - | 10.00 |
| TOTAL: | | | | | \$10.00 |

| PAYMENT INFORMATION | | | | |
|---|---------------|---|-------------|------------|
| NOTE: Items will appear on credit card statement as "Bureau of Land Mgmt CO". | | | | |
| 1 | AMOUNT: | 10.00 | POSTMARKED: | N/A |
| | TYPE: | CREDIT CARD | RECEIVED: | 09/06/2016 |
| | NAME: | MIYAUCHI, TERENCE 3408 SOUTHERN VISTA DR KINGMAN AZ 86401-0629 US | | |
| | CARD NO: | XXXXXXXXXXXX2420 | AUTH CODE: | 05242C |
| | NAME ON CARD: | TERENCE MIYAUCHI | | |
| | EXPIRES: | 07/2018 | | |
| | SIGNATURE: | | | |

| |
|---------|
| REMARKS |
| |

This receipt was generated by the automated BLM Collections and Billing System and is a paper representation of a portion of the official electronic record contained therein.

ENTERED
SEP - 7 2016
BY: 

UNITED STATES
DEPARTMENT OF THE INTERIOR
BUREAU OF LAND MANAGEMENT **342**

AMC426089
[Signature]

MAINTENANCE FEE WAIVER CERTIFICATION

FORM APPROVED
OMB NO. 1004-0114
Expires: October 31, 2016

SEE INSTRUCTIONS ON PAGE 2

1. This small miner waiver is filed for the assessment year beginning on September 1, 2015 and ending on September 1, 2016.
2. The undersigned and all related parties owned ten or fewer mining claims, mill, or tunnel sites located and maintained on Federal lands in the United States of America on September 1, 2015.
3. The undersigned have performed the assessment work required by law for each mining claim listed prior to filing this waiver and understand that by filing this form, the undersigned must file an affidavit of assessment work with the Bureau of Land Management (BLM) by the December 30th following the filing of this waiver.
4. The undersigned understand that if the assessment work obligation has not yet come due under 30 U.S.C. 28 (for those claims in their first assessment year only), a notice of intent to hold reciting this condition must be recorded by the December 30th following the filing of this waiver.
5. The undersigned understand that mill and tunnel sites may also be listed on this waiver and be waived from payment of the maintenance fee, and that a notice of intent to hold for these sites is required to be filed with the BLM by the December 30th following the filing of this waiver.
6. The undersigned understand and acknowledge that pursuant to 43 U.S.C. 1212 and 18 U.S.C. 1001, the filing or recording of a false, fictitious, or fraudulent document with the BLM may result in a fine of up to \$250,000, a prison term not to exceed five years, or both.
7. The mining claims, mill or tunnel sites for which this waiver from payment of the maintenance fees is requested are:

| CLAIM OR SITE NAME | BLM RECORDATION SERIAL NUMBER |
|------------------------|-------------------------------|
| 1. <u>Au Digger #1</u> | <u>AMC426089</u> ✓ |
| 2. | |
| 3. | |
| 4. | |
| 5. | |
| 6. | |
| 7. | |
| 8. | |
| 9. | |
| 10. | |

The owner(s) (claimants) of the above mining claims and sites are:

| | |
|---|--|
| <u>TERENCE S. MIYAUCHI</u> ✓ (Owner's Name - Please Print) | <u><i>[Signature]</i></u> (Owner's Signature) |
| <u>3408 SOUTHERN VISTA DR</u> (Owner's Mailing Address) | <u>KINGMAN</u> <u>AZ</u> <u>86401</u> (City) (State) (Zip Code) |
| _____ (Owner's Name - Please Print) | _____ (Owner's Signature) |
| <u>AL 483</u> _____ (Owner's Mailing Address) | _____ (City) (State) (Zip Code) |
| <u>PB</u> _____ (Owner's Name - Please Print) | <u>9-9-15</u> <u>NW CHECK</u> <u>Doob PB</u> _____ (Owner's Signature) |
| <u>PHOENIX, ARIZONA</u> _____ (Owner's Mailing Address) | _____ (City) (State) (Zip Code) |
| <u>2015-AUG-19 P 3:43</u> _____ (Owner's Name - Please Print) | <u>RECEIVED</u> <u>BLM AZ STATE OFFICE</u> _____ (Owner's Signature) |
| _____ (Owner's Mailing Address) | _____ (City) (State) (Zip Code) |

(Owner's Name - Please Print)

(Owner's Signature)

(Owner's Mailing Address)

(City)

(State)

(Zip Code)

(Owner's Name - Please Print)

(Owner's Signature)

(Owner's Mailing Address)

(City)

(State)

(Zip Code)

(Owner's Name - Please Print)

(Owner's Signature)

(Owner's Mailing Address)

(City)

(State)

(Zip Code)

(Owner's Name - Please Print)

(Owner's Signature)

(Owner's Mailing Address)

(City)

(State)

(Zip Code)

18 U.S.C. 1001 and 43 U.S.C. 1212 make it a crime for any person knowingly and willfully to make to any department or agency of the United States any false, fictitious or fraudulent statements or representations as to any matter within its jurisdiction.

INSTRUCTIONS

1. This certification is made under the provisions of 43 U.S.C. § 1744 and 30 U.S.C. §28-28k and the regulations thereunder (43 CFR Part 3830).
2. The claimant(s) must fill in the dates in paragraph 1 for the beginning and ending of the assessment year for which this waiver is sought.
3. The claimant(s) must fill in the date in paragraph 2 for the beginning of the assessment year for which this waiver is sought.
4. All claim and site names and BLM serial numbers must be listed for the mining claims, mill sites, and tunnel sites for which the waiver is sought.
5. All owners of the mining claims, mill sites, and tunnel sites and their addresses must be given.
6. This waiver form must be signed by all the claimants or their designated agent, in original form. If an agent is designated, a notarized designation of agent, signed by all of the claimants with proper address given, must be submitted with this waiver.
7. This form must be filed no later than September 1st for the upcoming assessment year in the BLM State Office where the mining claims or sites are recorded, or the waiver cannot be granted by the BLM. (Example: To obtain a waiver for the assessment year 2012, which begins on September 1, 2011, you must qualify for and file for a waiver no later than September 1, 2011, in the proper BLM State Office.)
8. For all mining claims which require assessment work, you must record an affidavit of labor on or before the December 30th immediately following the filing of this waiver. For all other mining claims or sites waived, you must record a notice of intent to hold on or before the December 30th immediately following the filing of this waiver.
9. Mill and tunnel sites may also be listed on this waiver and be waived from payment of the maintenance fee. A notice of intent to hold for these sites is required to be filed by the December 30th following the filing of this waiver.

PHOENIX, ARIZONA

FOR OFFICIAL USE ONLY

2015 AUG 19 P 3:43

RECEIVED
BLM AZ STATE OFFICE

2. Type of labor and improvements (specify what was done and give the total value for that labor and improvement to show at least \$100 for each claim). If a geological, geochemical, or geophysical survey was performed, as per 30 U.S.C. 28-1, reference the title of the report of survey, give cost and date of the survey and report, and indicate it was filed with the County Recorder:

| Description of Work Performed | Value of Work Performed | Date Work Was Performed |
|--------------------------------|-------------------------|-------------------------|
| Excavation of Prospect Pits | | Dec 20-Jan 3 2015 \$300 |
| Bulk Sampling of prospect PITS | | Jan-April 2015 \$200 |
| | | |
| | | |

3. Name and mailing address of each person who performed the labor and improvements:

Name (please print)

Terry Miyauchi

Jacob Miyauchi

Current Mailing Address (please print)

3408 Southern Vista Dr Kingman, AZ 86401

3408 Southern Vista Dr Kingman, AZ 86401

4. Name and mailing address of each person who holds and claims the subject mining claim(s) for the valuable minerals contained therein. Be sure to indicate if there is a change of address:

Name (please print)

Terry Miyauchi

Current Mailing Address (please print)

3408 Southern Vista Drive

RECEIVED
 MINN. STATE OFFICE
 2015 AUG 19 P 3:43
 PHOENIX, ARIZONA

5. The undersigned testifies that on the date of August 14, 2015, all monuments required by law were erected upon the subject claim(s), and all notices required by law were posted on the subject claim(s) or copies thereof were in place, and at said date, each corner monument bore or contained

markings sufficient to appropriately designate the corner of the claim to which it pertains and the name of the claim(s).

I hereby certify under penalty of perjury under the laws of the State of ARIZONA that the foregoing statements are true and correct:

Tom J. [Signature] Date: 8/17/15
(Signature of person responsible for above statement)

Title 18 U.S.C. 1001 and 43 U.S.C. 1212 make it a crime for any person knowingly and willfully to make to any department or agency of the United States any false, fictitious or fraudulent statements or representations as to any matter within its jurisdiction.

Notary Block

SUBSCRIBED AND SWORN TO before me, this 17 day of August 2015

By: Pamela A. Jones
(Signature of Affiant)

Title: Executive Assistant

My Commission Expires: 10/17/2016

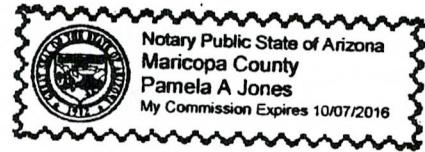

INSTRUCTIONS

1. This is an optional form that may be used to satisfy the requirements for the Bureau of Land Management (BLM) under the provisions of 43 U.S.C. §1744 and 30 U.S.C. §28-28d and the regulations thereunder (43 CFR part 3835). Since local and State laws may vary, you should contact your local and State agencies where the claims are located to ensure all applicable laws and requirements are satisfied.
2. The claimant(s) must fill in the date in paragraph 1 for the applicable assessment year and the county and state where the claims are located.
3. All claim names, BLM serial numbers, legal descriptions, and original county recording information must be listed for the claims pertaining to this assessment notice.
4. The claimant(s) must complete paragraph 2 listing all labor or improvements which was performed on or did benefit the subject mining claims. The value and date of the labor or improvements must also be listed. The total amount of labor or improvements can be listed, but the total expenditure must equal at least \$100 for each claim.
5. The names and current mailing addresses of the person(s) performing the labor shall be listed in paragraph 3.
6. The name and current mailing address of each owner (claimant) of the claims shall be listed in paragraph 4. The mailing address shall be the owner's address and not the address of an agent or anyone representing the claimant. Be sure to note if there has been a change of address.
7. Paragraph 5 shall be completed to show the date it was verified that all monuments required by law were properly erected, all notices were posted, and that corners were appropriately designated for all claims listed.
8. An exact legible reproduction or duplicate (other than microfilm or other electronic media) of this affidavit or another type of affidavit of assessment work that you file or will file in the county where each claim is located, must be filed with the BLM on or before December 30 of the calendar year in which the assessment year ends. For mill or tunnel sites, a separate notice of intent to hold must be filed with the BLM on or before December 30. Requirements for filing a notice of intent to hold can be found at 43 CFR 3835.33.
9. A processing fee of \$10 for each claim listed must be remitted to the BLM along with this or any other affidavit of assessment work.

RECEIVED
BLM AZ STATE OFFICE
2015 AUG 19 3:43

NOTICES

THE PRIVACY ACT and 43 CFR 2.48(d) require that you be furnished with the following information in connection with the information requested by this form.

AUTHORITY: 30 U.S.C. §28-28d and 43 CFR part 3835 permit collection of the information requested by this form.

PRINCIPAL PURPOSE: The BLM will use the information you provide to document compliance with 43 U.S.C. 1744 and that assessment work has been completed in accordance with 30 U.S.C. § 28-28d and 43 CFR part 3835 in lieu of paying the maintenance fee for the mining claims listed on this form.

ROUTINE USES: The BLM will only disclose this information in accordance with the provisions at 43 CFR 2.56(b) and (c).

EFFECT OF NOT PROVIDING INFORMATION: Disclosure of the requested information is required by 30 U.S.C. § 28-28d and 43 CFR part 3835 for claimants qualified to perform assessment work in lieu of paying the maintenance fee. Failure to submit all the requested information or to complete this form will delay the BLM's processing of the form and may preclude the BLM's acceptance of the assessment work information, which may result in forfeiture of the mining claim(s) by the claimant.

THE PAPERWORK REDUCTION ACT requires us to inform you that:

Use of this form is optional. You must perform assessment if a waiver to pay the maintenance fee has been requested. This form is provided to help you attest that annual assessment work has been completed in lieu of paying the maintenance fee for your claim(s). Submission of the requested information is necessary to obtain or retain a benefit.

You do not have to respond to this or any other Federal agency-sponsored information collection unless it displays a valid OMB control number.

BURDEN HOURS STATEMENT: The estimated public reporting burden for this form is 30 minutes per response, including the time for reviewing instructions, gathering and maintaining data, and completing and reviewing the form. You may submit comments regarding the burden estimate or any other aspect of this form to: U.S. Department of the Interior, Bureau of Land Management (1004-0114), Bureau Information Collection Clearance Officer (WO-630), 1849 C Street, N.W., Room 2134LM, Washington, D.C. 20240.

PHOENIX, ARIZONA

2015 AUG 19 P 3:43

RECEIVED
BLM AZ STATE OFFICE

United States Department of the Interior
Bureau of Land Management
 LANDS/RECREATION & PLANNING
 ONE N CENTRAL AVE
 PHOENIX, AZ 85004 -2203
 Phone: 602-417-9200

Receipt

No: 3371357

| | |
|--|--|
| Transaction #: 3469531 | |
| Date of Transaction: 08/19/2015 | |
| CUSTOMER: | |
| TERRANCE MIYAUCHI 3408 SOUTHERN VISTA DR KINGMAN, AZ 86401-0629 US | |

| LINE # | QTY | DESCRIPTION | REMARKS | UNIT PRICE | TOTAL |
|---------------|------|---|--------------------------|------------|----------------|
| 1 | 1.00 | LOCATABLE MINERALS / MINING CLAIMS- NOT NEW-UNADJUD, ONE AUTH NO. ONLY / MINING CLAIM MONEY RECEIVED CASES: AMC426089/\$10.00 | 2016 WAIV & 2015 POL (1) | - n/a - | 10.00 |
| TOTAL: | | | | | \$10.00 |

| PAYMENT INFORMATION | | | | | |
|---------------------|---------|--|-------------|------------|--|
| 1 | AMOUNT: | 10.00 | POSTMARKED: | N/A | |
| | TYPE: | CASH | RECEIVED: | 08/19/2015 | |
| | NAME: | MIYAUCHI, TERRANCE 3408 SOUTHERN VISTA DR KINGMAN AZ 86401-0629 US | | | |

| |
|---------|
| REMARKS |
| |

This receipt was generated by the automated BLM Collections and Billing System and is a paper representation of a portion of the official electronic record contained therein.

INTERESTED
 AUG 21 2015
 BY: *R. [Signature]*

UNITED STATES DEPARTMENT OF THE INTERIOR
BUREAU OF LAND MANAGEMENT

MC NATIONWIDE CLAIMANT LISTING
September 09, 2015

| Cust | AZ | National |
|--|----------|----------|
| | CLAIMANT | Total |
| MIYAUCHI TERRY 3408 SOUTHERN VISTA DR KINGMAN, AZ 86401-0629 | 1 | 1 |

Run Time: 08:57 AM

Department of the Interior
Bureau of Land Management
Public Land Statistics

Run Date: 09/09/2015

Nationwide Claimant Listing
(Mining Claim Only)

Selection Criteria

System Id = MC

Cust Nm Begins With MIYAUCHI T, MIYAUCHI TERRY

Loc Dt Between

Address Begins With

City Begins With

State Begins With

Case Disp = A

Total Rows Returned: 1

UNITED STATES
DEPARTMENT OF THE INTERIOR
BUREAU OF LAND MANAGEMENT
MAINTENANCE FEE WAIVER CERTIFICATION

1648

JML

AMC 426089
FORM APPROVED
OMB NO. 1004-0114
Expires: October 31, 2016

SEE INSTRUCTIONS ON PAGE 2

- This small miner waiver is filed for the assessment year beginning on September 1, 2014 and ending on September 1, 2015
- The undersigned and all related parties owned ten or fewer mining claims, mill, or tunnel sites located and maintained on Federal lands in the United States of America on September 1, 2014
- The undersigned have performed the assessment work required by law for each mining claim listed prior to filing this waiver and understand that by filing this form, the undersigned must file an affidavit of assessment work with the Bureau of Land Management (BLM) by the December 30th following the filing of this waiver.
- The undersigned understand that if the assessment work obligation has not yet come due under 30 U.S.C. 28 (for those claims in their first assessment year only), a notice of intent to hold reciting this condition must be recorded by the December 30th following the filing of this waiver.
- The undersigned understand that mill and tunnel sites may also be listed on this waiver and be waived from payment of the maintenance fee, and that a notice of intent to hold for these sites is required to be filed with the BLM by the December 30th following the filing of this waiver.
- The undersigned understand and acknowledge that pursuant to 43 U.S.C. 1212 and 18 U.S.C. 1001, the filing or recording of a false, fictitious, or fraudulent document with the BLM may result in a fine of up to \$250,000, a prison term not to exceed five years, or both.
- The mining claims, mill or tunnel sites for which this waiver from payment of the maintenance fees is requested are:

| CLAIM OR SITE NAME | BLM RECORDATION SERIAL NUMBER |
|------------------------|-------------------------------|
| 1. <u>AV DIGGER #1</u> | <u>AMC 426089</u> |
| 2. | |
| 3. | |
| 4. | |
| 5. | |
| 6. | |
| 7. | |
| 8. | |
| 9. | |
| 10. | |

The owner(s) (claimants) of the above mining claims and sites are:

| | |
|--|--|
| <u>TERRY MIYAUCHI</u> (Owner's Name - Please Print) | <u><i>JML</i></u> (Owner's Signature) |
| <u>3408 SOUTHERN VISTA DR</u> (Owner's Mailing Address) | <u>KINGMAN</u> <u>AZ</u> <u>86401</u> (City) (State) (Zip Code) |
| _____ (Owner's Name - Please Print) | _____ (Owner's Signature) |
| _____ (Owner's Mailing Address) | _____ (City) (State) (Zip Code) |
| _____ (Owner's Name - Please Print) | _____ (Owner's Signature) |
| _____ (Owner's Mailing Address) | _____ (City) (State) (Zip Code) |
| _____ (Owner's Name - Please Print) | _____ (Owner's Signature) |
| _____ (Owner's Mailing Address) | _____ (City) (State) (Zip Code) |

INTERESTED
SEP 15 2015
BY: *JML*

RECEIVED
BLM AZ STATE OFFICE
2014 AUG 27 P 1:15
PHENIX, ARIZONA

(Continued on page 2)

nmv
9/23/2014
nmv

2

FEE# 2014037372

OFFICIAL RECORDS OF MOHAVE COUNTY CAROL MEIER, COUNTY RECORDER



426089

08/26/2014 04:33 PM Fee: \$10.00

PAGE: 1 of 2

NOTICE OF INTENTION TO HOLD MINING CLAIMS/SITES

When Recorded Return Document to:

TERILY MIYAUCHI
3408 SOUTHERN VISTA DR
KINGMAN AZ 86401

RECEIVED
BLM AZ STATE OFFICE
2014 AUG 27 P 1:14
PHOENIX, ARIZONA
BLM
Date
Stamp

Check here if this is a change of address.

Telephone: 928-279-2274

E-mail Address TERILYKEM@CETLINK.NET

I (We) intend to hold the claims(s) and/or site(s) listed below for the calendar year 2015, and I (We) have filed or will file a Notice of Intent to Hold in the county where the claim (s) is located.

Reason for filing a Notice of Intent to Hold instead of an assessment work filing (check one):

- Maintenance fee was paid to maintain claim(s) during this assessment year.
Mill or tunnel sites.
Claim(s) was located during the current assessment year.
BLM has deferred assessment work (attach copy of decision granting deferment, or pending petition for deferment including date petition was filed.)

Table with 7 columns: Line No., AMC NUMBER, CLAIM/SITE NAME, COUNTY RECORDER DATA (If available), TWP, RNG, SEC. Row 1 contains handwritten data: 1, 426089, AV DIGGER #1, 29N, 17W, 22.

ENTERED
SEP 15 2014
BY: [Signature]

NOTICE OF INTENTION TO HOLD MINING CLAIMS/SITES
page 2

RECEIVED
BLM AZ STATE OFFICE
2014 AUG 27 P 1:15
PHOENIX, ARIZONA
BLM
Date
Stamp

1. State of Arizona, County of MOHAVE

2. I (Name) TERRY MIYAUCHI

3. Reside at (Address) 3708 SOUTHERN VISTA DR

City KINGMAN County MOHAVE State AZ Zip 86401 being duly sworn, depose and say that I am a citizen of the United States, more than eighteen years of age, that all of the facts set forth in this notice, subject to the provisions and penalties of 18 U.S.C. 1001 pertaining to the filing of false, fictitious, or fraudulent statements with the United States, are true and correct according to the best of my knowledge, information and belief.

4. Owner's name and address (If not shown in Items 1-3 above). _____

5. Dated: 8/26/14 Signature: 

Bureau of Land Management
Arizona State Office
www.az.blm.gov

No. of Claims: 1 x \$10 = 10
Check No: 2936 Init. AME
Receipt No.: 3115253
For BLM Use Only

August 26, 2014

Bureau of Land Management
One North Central Ave., STE. 800
Arizona State Office
Phoenix, AZ 85004-4427

To whom it may concern,

Attached is form MCF 3830-2 (Maintenance Fee Waiver Certification), form MCF 110 (Notice of Intention to Hold Mining Claims/Sites), and the \$10 processing fee. It is our first time renewing the claim and applying for the Maintenance Fee Waiver so we included the Notice of Intention to Hold Mining Claims/Sites. Additionally we will submit the Affidavit of Performance of Annual Work by December 30, 2015. If any additional information or corrections are needed please contact me at:

Phone: (928)-279-2274 or (928-303-0554)

Email: jmiyauchi@citlink.net or terrykim@citlink.net

Address: 3408 Southern Vista Drive, Kingman, AZ, 86401



Terry Miyauchi

PHOENIX, ARIZONA
2014 AUG 27 P 1:12
RECEIVED
BLM AZ STATE OFFICE

Terence Scott Miyauchi

3408 Southern Vista Dr
Kingman AZ 86401-0629



RECEIVED
BLM AZ STATE OFFICE

2014 AUG 27 P 1:07

PHOENIX, ARIZONA

BLM
ONE NORTH CENTRAL AVE STE 800
ARIZONA STATE OFFICE
PHOENIX, AZ 85004-4427

**United States Department of the Interior
Bureau of Land Management
LANDS/RECREATION & PLANNING
ONE N CENTRAL AVE
PHOENIX, AZ 85004 -2203
Phone: 602-417-9200**

Receipt

No: 3115253

| | |
|--|--|
| Transaction #: 3206994 | |
| Date of Transaction: 08/28/2014 | |
| CUSTOMER: | |
| TERRANCE MIYAUCHI 3408 SOUTHERN VISTA DR KINGMAN, AZ 86401-0629 US | |

| LINE # | QTY | DESCRIPTION | REMARKS | UNIT PRICE | TOTAL |
|---------------|------|--|-------------------|------------|----------------|
| 1 | 1.00 | LOCATABLE MINERALS / MINING CLAIMS- NOT NEW-UNADJUD, ONE AUTH NO. ONLY / MINING CLAIM MONEY RECEIVED CASES: AMC426089/\$10.00 | NOI 2014/1 WAV | - n/a - | 10.00 |
| TOTAL: | | | | | \$10.00 |

| PAYMENT INFORMATION | | | | | |
|---------------------|-----------|--|-------------|------------|--|
| 1 | AMOUNT: | 10.00 | POSTMARKED: | N/A | |
| | TYPE: | CHECK | RECEIVED: | 08/28/2014 | |
| | CHECK NO: | 2936 | | | |
| | NAME: | MIYAUCHI, TERRANCE 3408 SOUTHERN VISTA DR KINGMAN AZ 86401-0629 US | | | |

| |
|--|
| REMARKS |
| PAYMENT WAS NOT MAILED IT WAS DROPPED OFF IN THE PUBLIC ROOM |

This receipt was generated by the automated BLM Collections and Billing System and is a paper representation of a portion of the official electronic record contained therein.

NOTICE!!

These documents have been scanned!

Do not place un-scanned documents beneath this notice!

Do not remove this notice from this file!

GPO Jacket No. 560-102
Print Order 61540
Rise Business Services, LLC
Job=AZ15 5/10/2019



Box Number= AZ15035



Claim Begin-End: AMC426089-AMC426089

6 Location Notices-Amendments and Supporting Documents



AZ15035-21

AMC425596-AMC426147

**DEPARTMENT OF THE INTERIOR
BUREAU OF LAND MANAGEMENT
MINING CLAIMS**

(LIVE) Serial Register Page

Run Date/Time: 01/07/2014 04:32 PM

Page 1 of 1

01 10-21-1976;090STAT0090;43USC1744
Case Type 384201: PLACER CLAIM
Claim Name: AU DIGGER
Commodity :
Case Disposition: ACTIVE
Required Maintenance Fee: \$140.00

Total Acres
20.000

Serial Number
AMC426089
Lead File Number
AMC426089

| Name & Address | Int Rel |
|--|----------|
| MIYAUCHI TERRY 3408 SOUTHERN VISTA DR KINGMAN, AZ 86401-0629 | CLAIMANT |

| Mer Twp | Rng | Sec | Quadrant | District/Field Office | County |
|---------|-------|-------|----------|-----------------------|--------|
| 14 | 0290N | 0170W | 022 SW | KINGMAN FO | MOHAVE |

| Act Date | Code | Action | Action Remarks | Receipt Number |
|------------|------|----------------------------|----------------|----------------|
| 12/23/2013 | 403 | LOCATION DATE | | |
| 12/30/2013 | 395 | RECORDATION NOTICE RECD | 1 | 2942589 |
| 12/30/2013 | 484 | LOCATION YEAR / MAINTENANC | 2014;\$140 | 2942589 |
| 12/30/2013 | 501 | ACCT ADV IN LEAD FILE | AMC426089; | |
| 12/23/2013 | 404 | COUNTY RECORDATION | 2013063572; | |

Line Nr Remarks

MINING CLAIM STATUS REPORT

Data Entered: 1/7/2014 PM

MTP Checked By: [Signature]
GEO Checked By: [Signature]

LEAD SERIAL NUMBER: AMC 426089 thru AMC _____

NUMBER OF CLAIMS & TYPE:

LODE _____
PLACER 1 _____
ASSOCIATION PLACER _____
MILL SITE _____
TUNNEL SITE _____

CHARGES:

Location Fee @ \$34 = \$ 34
Processing Fee @ \$20 = \$ 20
Maintenance Fee @ \$140 = \$ 140
Add'l Maint Fee for Assoc Placer = \$ _____
SUBTOTAL \$ _____
Other Fees \$ _____
Other Fees \$ _____
TOTAL \$ 194

TOTAL ACREAGE: _____ Per Claim
(Placer Only)

NUMBER OF LOCATORS: _____

DOCUMENTS RECEIVED VIA: Over-the-Counter [] Mail [] **TIMELY FILED:** Yes [] No []

LEGAL DESCRIPTION: T 29N R 17W SEC 22
T _____ R _____ SEC _____
T _____ R _____ SEC _____
T _____ R _____ SEC _____
T _____ R _____ SEC _____

BLM [] FOREST SERVICE [] _____ SUBJ TO PL 359: Yes [] No []
WILDERNESS AREA [] _____

SPLIT ESTATE: N/A [] SX [] PX [] OTHER [] _____
SRHA [] Was proper Notice filed if located on SHRA Land? Yes [] No []

RECONVEYED MINERALS ON BLM LAND REQUIRE OPENING ORDER FROM 1944 TO 1993:

Open to Entry On _____ N/A []

COMMENTS/STATUS: VOID [] PARTIALLY VOID [] PVT MINERALS [] WITHDRAWN LANDS []
OTHER [] _____

A110426089

[] Claimant acknowledges that portions of the following claim(s) site(s) may be void or voidable.

Printed Name of Claimant _____ Signature of Claimant _____

*****FINAL ADJUDICATION*****

DATE 6/2/14 INITIALS AT

2

FEE# 2013063572

OFFICIAL RECORDS OF MOHAVE COUNTY CAROL MEIER, COUNTY RECORDER



12/23/2013 11:21 AM Fee: \$10.00

PAGE: 1 of 2

LOCATION NOTICE FOR PLACER MINING CLAIM

NOTICE IS HEREBY GIVEN that the Au DIGGER #1 placer mining claim has been located by TERRY MIYAUCHI whose current mailing address is 3408 SOUTHERN VISTA DR., KINGMAN, AZ 86401

RET#

RECEIVED DEPT. OF STATE OFFICE PHOENIX, ARIZONA 2013 DEC 30 PM 3:27 BLM Date Stamp

The general course of this claim is 20 ACRES and it is situated in MOHAVE County, Arizona.

This claim is 1320 feet in length and 660 feet in width. This claim runs from the location monument on which this location notice is posted approximately 660 feet in a SOUTH direction to the SE end line and 1320 feet in a W direction to the SW end line. This claim is marked by four monuments, one at each corner of the claim.

The location monument on which this notice is posted is situated within Section 22, Township 29 N, Range 17 W, Gila Salt River Base and Meridian, Arizona. This claim encompasses portions of the following legal subdivision(s) if located by legal subdivision or the following quarter section (s), section (s), Township (s) and Range (s) S 1/2, SE 1/4, SW 1/4, SECTION 20, T.29 N, R.17 W, Gila Salt River Base and Meridian, Arizona.

The locality of this claim with reference to some natural object or permanent monument and additional information (if any) concerning its locality are as follows: 1/2 MILE WEST OF PIERCE. FAZLY RD, DUE SOUTH OF LUCKY LANE 1122 CLAIM

DATED AND POSTED on the ground this 23 day of DECEMBER, 2013.

LOCATOR (s) [Signature] TERRY MIYAUCHI

Form MCF102 Revised July 2005

AN0426089

MINING CLAIM MAP

Lode () Placer (X)

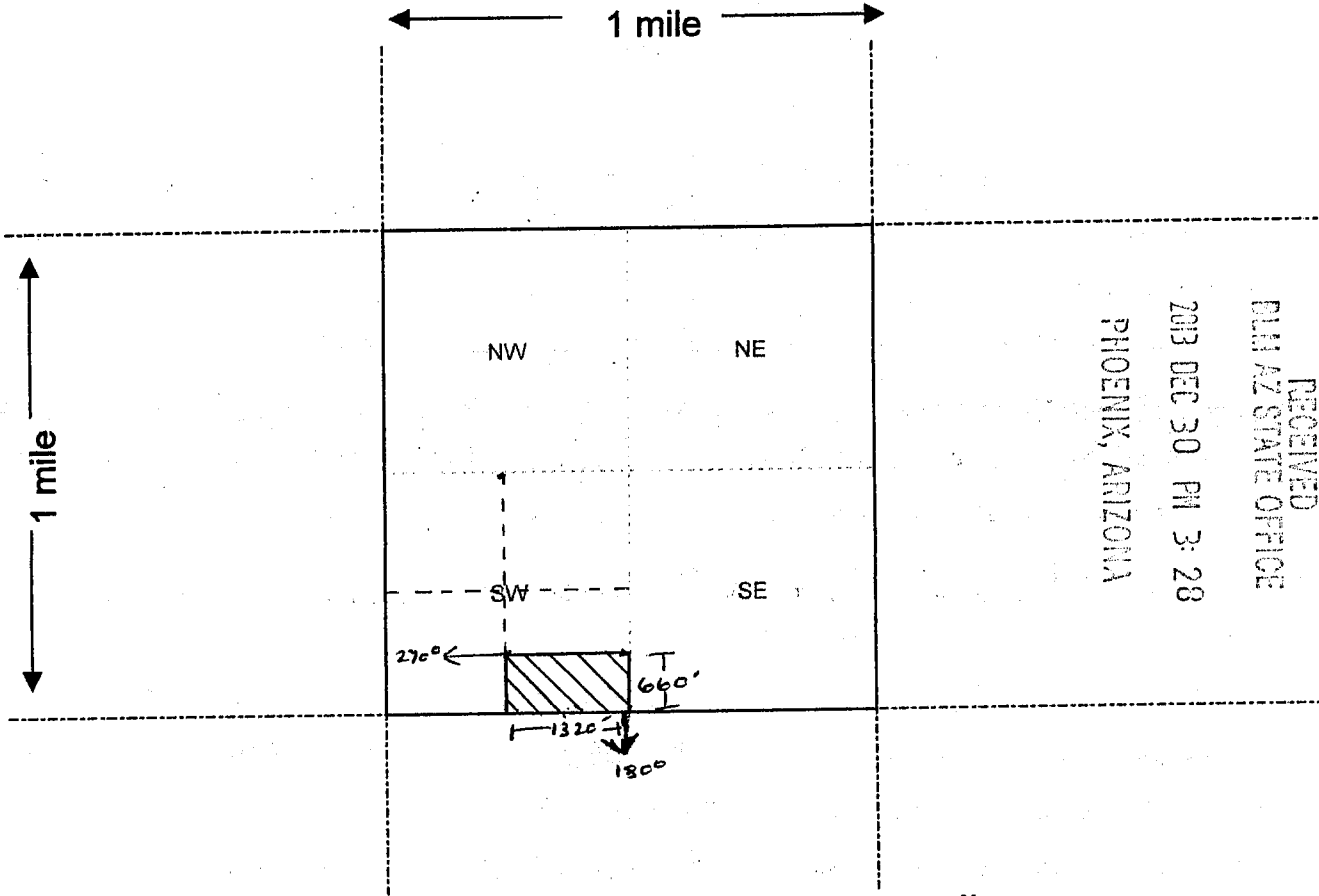

Scale : 1" = 2000 feet



1. The above map depicts the AU DIGGER #1 mining claim, which is located in Section (s) 22, Township 29 N, Range 17 W, Gila and Salt River Base and Meridian, MOHAVE County, Arizona.
2. The type of corner and location monuments used are as follows: CAPPED PVC PIPE
4" WIDE, 3.5' HIGH
3. The bearings and distances in degrees and feet between claim corners are as depicted on the map.

Form MCF100a
Revised July 2005

This form is available from the Arizona Department of Mines & Mineral Resources and may be reproduced.

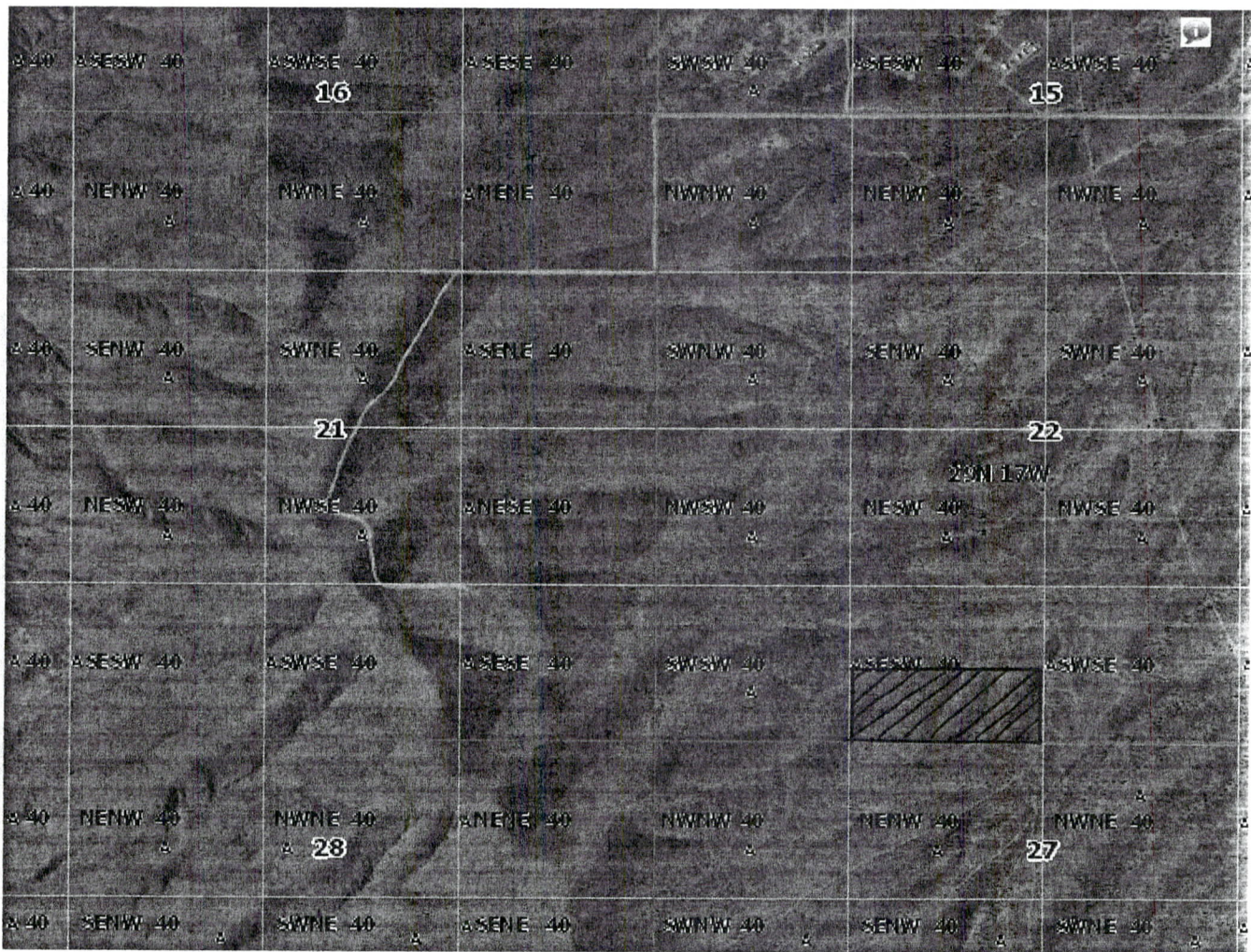

SECTION 22
 TOWNSHIP 29 N
 RANGE 17 W

SOUTH 1/2, SOUTHEAST 1/4, SW 1/4

RECEIVED
 BLM AZ STATE OFFICE
 PHOENIX, ARIZONA
 2013 DEC 30 PM 3: 27

AH0426089

0 0 mi

December 23, 2013

Bureau of Land Management
One North Central Ave., Ste. 800
Arizona State Office
Phoenix, AZ 85004-4427

To whom it may concern,

Attached is a Form MCF102 (Location Notice for Placer Mining Claim) and Form MCF100a (Mining Claim Map) for your review. Also enclosed is a check in the amount of \$194.00. If any additional information is required please contact me at:

PHONE: 928-279-2274

EMAIL: terrykim@citlink.net

ADDRESS: 3408 Southern Vista Drive, Kingman, AZ 86401

Additionally the forms have been recorded with the Mohave County Records Office.



Terry Miyauchi

RECEIVED
BLM AZ STATE OFFICE
2013 DEC 30 PM 3:27
PHOENIX, ARIZONA

A11C1126089

DEPARTMENT OF INTERIOR
BUREAU OF LAND MANAGEMENT

Input Parameters for Geographic Report with Land

System Id = CR

Admin State = AZ

Geo State =

Casetype Begins With

Case Disp Txt = AUTHORIZED, CANCELLED, EXPIRED, PENDING, REJECTED, RELINQUISHED, VOID, WITHDRAWN

Mer Twp Rng = 14 0290N 0170W

Section = 022, 999

Mtrs =

Commodity =

Commodity Txt =

Pending Org =

Pend Org Decode =

Total Rows Returned: 5

RUN TIME: 03:46 PM

UNITED STATES DEPARTMENT OF INTERIOR
BUREAU OF LAND MANAGEMENT
GEOGRAPHIC REPORT WITH LAND
Sorted by Serial Number

RUN DATE: 01/07/2014
Page 1 of 1

Adm State: AZ

Serial Number: AZA 017637
Total Case Acres: 48.790

| <u>Casetype</u> | <u>Case Disp</u> | 14 | 0290N | 0170W | <u>Sect</u> | <u>Sur Typ</u> | <u>Sur Num</u> | <u>Suff</u> | <u>Subdivision</u> | <u>Act Pend</u> |
|-----------------|------------------|----|-------|-------|-------------|----------------|----------------|-------------|--------------------|-----------------|
| 281001 | AUTHORIZED | | | | 022 | MNR | | 1 | E2E2E2; | |

Serial Number: AZA 017637B
Total Case Acres: 48.790

| <u>Casetype</u> | <u>Case Disp</u> | 14 | 0290N | 0170W | <u>Sect</u> | <u>Sur Typ</u> | <u>Sur Num</u> | <u>Suff</u> | <u>Subdivision</u> | <u>Act Pend</u> |
|-----------------|------------------|----|-------|-------|-------------|----------------|----------------|-------------|--------------------|-----------------|
| 282201 | AUTHORIZED | | | | 022 | MNR | | 1 | E2E2E2; | |

Serial Number: AZA 022299
Total Case Acres: 0.035

| <u>Casetype</u> | <u>Case Disp</u> | 14 | 0290N | 0170W | <u>Sect</u> | <u>Sur Typ</u> | <u>Sur Num</u> | <u>Suff</u> | <u>Subdivision</u> | <u>Act Pend</u> |
|-----------------|------------------|----|-------|-------|-------------|----------------|----------------|-------------|--------------------|-----------------|
| 285003 | AUTHORIZED | | | | 022 | MNR | | 1 | SESESE; | |

Serial Number: AZA 033055
Total Case Acres: 5.091

| <u>Casetype</u> | <u>Case Disp</u> | 14 | 0290N | 0170W | <u>Sect</u> | <u>Sur Typ</u> | <u>Sur Num</u> | <u>Suff</u> | <u>Subdivision</u> | <u>Act Pend</u> |
|-----------------|------------------|----|-------|-------|-------------|----------------|----------------|-------------|--------------------|-----------------|
| 281001 | AUTHORIZED | | | | 022 | MNR | | | N2N2N2; | |

Serial Number: AZA 035834
Total Case Acres: 1.000

| <u>Casetype</u> | <u>Case Disp</u> | 14 | 0290N | 0170W | <u>Sect</u> | <u>Sur Typ</u> | <u>Sur Num</u> | <u>Suff</u> | <u>Subdivision</u> | <u>Act Pend</u> |
|-----------------|------------------|----|-------|-------|-------------|----------------|----------------|-------------|--------------------|-----------------|
| 380910 | AUTHORIZED | | | | 022 | ALIQ | | | NE; | |

Terence Scott Miyauchi
3408 Southern Vista Dr
Kingman AZ 86401-0629

RECEIVED
BLM AZ STATE OFFICE

2013 DEC 30 PM 2: 59

PHOENIX, ARIZONA

BLM

ARIZONA STATE OFFICE

ONE NORTH CENTRAL AVE

SFE. 800

PHOENIX, AZ 85004-4427

85004442700



A5323 12 15233340



FOREVER

